



Armaturen GmbH

Armaturen, Rohre, Sonderteile aus Edelstahl
fittings, pipes, special parts of stainless steel

Rohre
pipes



Armaturen GmbH

fon + 49 (0) 44 65 8 07 0
fax + 49 (0) 44 65 8 07 40



Armaturen GmbH

fon: + 49 (0) 44 65 8 07 0
fax: + 49 (0) 44 65 8 07 40

8 Rohre
8 pipes



Das Lieferprogramm beinhaltet u. a. sämtliche Abmessungen von Getränkeleitungsrohren in den beiden Werkstoffen 1.4301/1.4307 und 1.4404. Natürlich können Sie davon abweichende Rohr-abmessungen auf Anfrage erhalten.



Rohre
Pipes

The delivery program includes all dimensions of beverage pipes in both materials 1.4301/1.4307 and 1.4404. Certainly you can get on request pipe dimensions which differ from these dimensions.

8.01 Rohr AISI 304/304L
8.01 pipe AISI 304/304L

Art.-Nr. 800-							AISI 304/304L-1.4301/1.4307							
DN	A	B	C	D	E	Gew.	Art.-Nr.	Preis	Art.-Nr.	Preis	Art.-Nr.	Preis	Art.-Nr.	Preis
mm	mm	mm	mm	mm	mm	kg/m	CC	EUR	CD	EUR	BC	EUR	BD	EUR
15	18,0	1,50				0,620	-101801502	(+)	-201801502	(+)	-301801502	(+)	-401801502	(+)
15	19,0	1,50				0,657	-101901502	(+)	-201901502	(+)	-301901502	(+)	-401901502	(+)
20	22,0	1,00				0,526	-102201002	(+)	-202201002	(+)	-302201002	(+)	-402201002	(+)
20	22,0	1,50				0,770	-102201502	(+)	-202201502	(+)	-302201502	(+)	-402201502	(+)
20	23,0	1,50				0,808	-102301502	(+)	-202301502	(+)	-302301502	(+)	-402301502	(+)
1"	25,4	1,20				0,727	-102541202	(+)	-202541202	(+)	-302541202	(+)	-402541202	(+)
1"	25,4	1,25				0,730	-102541252	(+)	-202541252	(+)	-302541252	(+)	-402541252	(+)
1"	25,4	1,50				0,898	-102541502	(+)	-202541502	(+)	-302541502	(+)	-402541502	(+)
25	28,0	1,00				0,676	-102801002	(+)	-202801002	(+)	-302801002	(+)	-402801002	(+)
25	28,0	1,50				0,995	-102801502	(+)	-202801502	(+)	-302801502	(+)	-402801502	(+)
25	29,0	1,50				1,033	-102901502	(+)	-202901502	(+)	-302901502	(+)	-402901502	(+)
1,25"	31,8	1,25				0,956	-103181252	(+)	-203181252	(+)	-303181252	(+)	-403181252	(+)
1,25"	31,8	1,50				1,138	-103181502	(+)	-203181502	(+)	-303181502	(+)	-403181502	(+)
32	34,0	1,00				0,826	-103401002	(+)	-203401002	(+)	-303401002	(+)	-403401002	(+)
32	34,0	1,50				1,221	-103401502	(+)	-203401502	(+)	-303401502	(+)	-403401502	(+)
32	35,0	1,50				1,258	-103501502	(+)	-203501502	(+)	-303501502	(+)	-403501502	(+)
1,5"	38,1	1,25				1,153	-103811252	(+)	-203811252	(+)	-303811252	(+)	-403811252	(+)
1,5"	38,1	1,50				1,375	-103811502	(+)	-203811502	(+)	-303811502	(+)	-403811502	(+)
40	40,0	1,00				0,977	-104001002	(+)	-204001002	(+)	-304001002	(+)	-404001002	(+)
40	40,0	1,50				1,446	-104001502	(+)	-204001502	(+)	-304001502	(+)	-404001502	(+)
40	41,0	1,50				1,484	-104101502	(+)	-204101502	(+)	-304101502	(+)	-404101502	(+)
2"	50,8	1,25				1,551	-105081252	(+)	-205081252	(+)	-305081252	(+)	-405081252	(+)
2"	50,8	1,50				1,852	-105081502	(+)	-205081502	(+)	-305081502	(+)	-405081502	(+)
50	52,0	1,00				1,277	-105201002	(+)	-205201002	(+)	-305201002	(+)	-405201002	(+)
50	52,0	1,50				1,897	-105201502	(+)	-205201502	(+)	-305201502	(+)	-405201502	(+)
50	53,0	1,50				1,934	-105301502	(+)	-205301502	(+)	-305301502	(+)	-405301502	(+)
2,5"	63,5	1,50				2,329	-106351502	(+)	-206351502	(+)	-306351502	(+)	-406351502	(+)
2,5"	63,5	1,65				2,529	-106351652	(+)	-206351652	(+)	-306351652	(+)	-406351652	(+)
65	70,0	2,00				3,405	-107002002	(+)	-207002002	(+)	-307002002	(+)	-407002002	(+)
3"	76,1	1,50				2,984	-107611502	(+)	-207611502	(+)	-307611502	(+)	-407611502	(+)
3"	76,1	1,65				3,100	-107611652	(+)	-207611652	(+)	-307611652	(+)	-407611652	(+)
3"	76,1	2,00				3,711	-107612002	(+)	-207612002	(+)	-307612002	(+)	-407612002	(+)
80	85,0	2,00				4,157	-108502002	(+)	-208502002	(+)	-308502002	(+)	-408502002	(+)
4"	101,6	1,50				3,760	-110161502	(+)	-210161502	(+)	-310161502	(+)	-410161502	(+)
4"	101,6	2,00				4,988	-110162002	(+)	-210162002	(+)	-310162002	(+)	-410162002	(+)
100	104,0	2,00				5,108	-110402002	(+)	-210402002	(+)	-310402002	(+)	-410402002	(+)
125	129,0	2,00				6,360	-112902002	(+)	-212902002	(+)	-312902002	(+)	-412902002	(+)
150	154,0	2,00				7,612	-115402002	(+)	-215402002	(+)	-315402002	(+)	-415402002	(+)

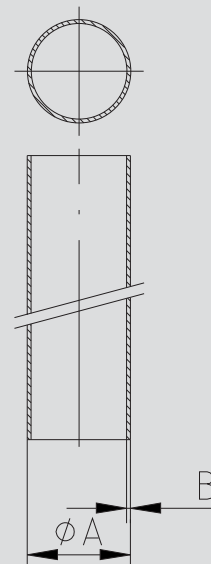
**Getränkeleitungsrohr
DIN 11850 und Zoll**
**beverage pipe
DIN 11850 and inch**

 CC: ungeglüht matt - CD: ungeglüht geschliffen
 BC: geglüht matt - BD: geglüht geschliffen
 (+) Preis auf Anfrage

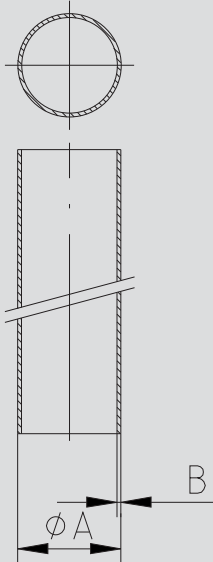
 CC: not annealed, descaled - CD: not annealed, grinded
 BC: annealed, descaled - BD: annealed, grinded
 (+) price on inquiry

8.02 Rohr AISI 316L
8.02 pipe AISI 316L
**Getränkeleitungsrohr
DIN 11850 und Zoll**
**beverage pipe
DIN 11850 and inch**

Art.-Nr. 800-							AISI 316L-1.4404							
DN	A	B	C	D	E	Gew.	Art.-Nr.	Preis	Art.-Nr.	Preis	Art.-Nr.	Preis	Art.-Nr.	Preis
mm	mm	mm	mm	mm	mm	kg/m	CC	EUR	CD	EUR	BC	EUR	BD	EUR
15	18,0	1,50				0,620	-101801504	(+)	-201801504	(+)	-301801504	(+)	-401801504	(+)
15	19,0	1,50				0,657	-101901504	(+)	-201901504	(+)	-301901504	(+)	-401901504	(+)
20	22,0	1,00				0,526	-102201004	(+)	-202201004	(+)	-302201004	(+)	-402201004	(+)
20	22,0	1,50				0,770	-102201504	(+)	-202201504	(+)	-302201504	(+)	-402201504	(+)
20	23,0	1,50				0,808	-102301504	(+)	-202301504	(+)	-302301504	(+)	-402301504	(+)
1"	25,4	1,20				0,727	-102541204	(+)	-202541204	(+)	-302541204	(+)	-402541204	(+)
1"	25,4	1,25				0,730	-102541254	(+)	-202541254	(+)	-302541254	(+)	-402541254	(+)
1"	25,4	1,50				0,898	-102541504	(+)	-202541504	(+)	-302541504	(+)	-402541504	(+)
25	28,0	1,00				0,676	-102801004	(+)	-202801004	(+)	-302801004	(+)	-402801004	(+)
25	28,0	1,50				0,995	-102801504	(+)	-202801504	(+)	-302801504	(+)	-402801504	(+)
25	29,0	1,50				1,033	-102901504	(+)	-202901504	(+)	-302901504	(+)	-402901504	(+)
1,25"	31,8	1,25				0,956	-103181254	(+)	-203181254	(+)	-303181254	(+)	-403181254	(+)
1,25"	31,8	1,50				1,138	-103181504	(+)	-203181504	(+)	-303181504	(+)	-403181504	(+)
32	34,0	1,00				0,826	-103401004	(+)	-203401004	(+)	-303401004	(+)	-403401004	(+)
32	34,0	1,50				1,221	-103401504	(+)	-203401504	(+)	-303401504	(+)	-403401504	(+)
32	35,0	1,50				1,258	-103501504	(+)	-203501504	(+)	-303501504	(+)	-403501504	(+)
1,5"	38,1	1,25				1,153	-103811254	(+)	-203811254	(+)	-303811254	(+)	-403811254	(+)
1,5"	38,1	1,50				1,375	-103811504	(+)	-203811504	(+)	-303811504	(+)	-403811504	(+)
40	40,0	1,00				0,977	-104001004	(+)	-204001004	(+)	-304001004	(+)	-404001004	(+)
40	40,0	1,50				1,446	-104001504	(+)	-204001504	(+)	-304001504	(+)	-404001504	(+)
40	41,0	1,50				1,484	-104101504	(+)	-204101504	(+)	-304101504	(+)	-404101504	(+)
2"	50,8	1,25				1,551	-105081254	(+)	-205081254	(+)	-305081254	(+)	-405081254	(+)
2"	50,8	1,50				1,852	-105081504	(+)	-205081504	(+)	-305081504	(+)	-405081504	(+)
50	52,0	1,00				1,277	-105201004	(+)	-205201004	(+)	-305201004	(+)	-405201004	(+)
50	52,0	1,50				1,897	-105201504	(+)	-205201504	(+)	-305201504	(+)	-405201504	(+)
50	53,0	1,50				1,934	-105301504	(+)	-205301504	(+)	-305301504	(+)	-405301504	(+)
2,5"	63,5	1,50				2,329	-106351504	(+)	-206351504	(+)	-306351504	(+)	-406351504	(+)
2,5"	63,5	1,65				2,529	-106351654	(+)	-206351654	(+)	-306351654	(+)	-406351654	(+)
65	70,0	2,00				3,405	-107002004	(+)	-207002004	(+)	-307002004	(+)	-407002004	(+)
3"	76,1	1,50				2,984	-107611504	(+)	-207611504	(+)	-307611504	(+)	-407611504	(+)
3"	76,1	1,65				3,100	-107611654	(+)	-207611654	(+)	-307611654	(+)	-407611654	(+)
3"	76,1	2,00				3,711	-107612004	(+)	-207612004	(+)	-307612004	(+)	-407612004	(+)
80	85,0	2,00				4,157	-108502004	(+)	-208502004	(+)	-308502004	(+)	-408502004	(+)
4"	101,6	1,50				3,760	-110161504	(+)	-210161504	(+)	-310161504	(+)	-410161504	(+)
4"	101,6	2,00				4,988	-110162004	(+)	-210162004	(+)	-310162004	(+)	-410162004	(+)
100	104,0	2,00				5,108	-110402004	(+)	-210402004	(+)	-310402004	(+)	-410402004	(+)
125	129,0	2,00				6,360	-112902004	(+)	-212902004	(+)	-312902004	(+)	-412902004	(+)
150	154,0	2,00				7,612	-115402004	(+)	-215402004	(+)	-315402004	(+)	-415402004	(+)

 CC: ungeglüht matt - CD: ungeglüht geschliffen
 BC: geblüht matt - BD: geblüht geschliffen
 (+) Preis auf Anfrage

 CC: not annealed, descaled - CD: not annealed, grinded
 BC: annealed, descaled - BD: annealed, grinded
 (+) price on inquiry

8.03 Vierkantrohr AISI 304/304L
8.03 square/rectangle pipe AISI 304/304L

Art.-Nr. 81-							AISI 304/304L-1.4301/1.4307			
DN	A	B	C	D	E	Gew.	Art.-Nr.	Preis	Art.-Nr.	Preis
mm	mm	mm	mm	mm	mm	kg/m	geschliffen	EUR	matt	EUR
15x15x1,5	15,0	15,0	1,5			0,660	-1501500151	(+)	-1501500152	(+)
20x10x1,5	20,0	10,0	1,5			0,660	-1502000101	(+)	-1502000102	(+)
20x20x1,5	20,0	20,0	1,5			0,883	-1502000201	(+)	-1502000202	(+)
25x15x1,5	25,0	15,0	1,5			0,883	-1502500151	(+)	-1502500152	(+)
25x25x1,5	25,0	25,0	1,5			1,146	-1502500251	(+)	-1502500252	(+)
30x15x1,5	30,0	15,0	1,5			0,995	-1503000151	(+)	-1503000152	(+)
30x20x1,5	30,0	20,0	1,5			1,146	-1503000201	(+)	-1503000202	(+)
30x30x1,5	30,0	30,0	1,5			1,371	-1503000301	(+)	-1503000302	(+)
40x20x1,5	40,0	20,0	1,5			1,371	-1504000201	(+)	-1504000202	(+)
40x30x1,5	40,0	30,0	1,5			1,620	-1504000301	(+)	-1504000302	(+)
40x40x1,5	40,0	40,0	1,5			1,859	-1504000401	(+)	-1504000402	(+)
50x25x1,5	50,0	25,0	1,5			1,758	-1505000251	(+)	-1505000252	(+)
50x30x1,5	50,0	30,0	1,5			1,859	-1505000301	(+)	-1505000302	(+)
50x50x1,5	50,0	50,0	1,5			2,329	-1505000501	(+)	-1505000502	(+)
60x30x1,5	60,0	30,0	1,5			2,122	-1506000301	(+)	-1506000302	(+)
60x40x1,5	60,0	40,0	1,5			2,329	-1506000401	(+)	-1506000402	(+)
20x20x2,0	20,0	20,0	2,0			1,152	-2002000201	(+)	-2002000202	(+)
25x25x2,0	25,0	25,0	2,0			1,495	-2002500251	(+)	-2002500252	(+)
30x20x2,0	30,0	20,0	2,0			1,495	-2003000201	(+)	-2003000202	(+)
30x30x2,0	30,0	30,0	2,0			1,840	-2003000301	(+)	-2003000302	(+)
35x35x2,0	35,0	35,0	2,0			2,150	-2003500351	(+)	-2003500352	(+)
40x20x2,0	40,0	20,0	2,0			1,840	-2004000201	(+)	-2004000202	(+)
40x30x2,0	40,0	30,0	2,0			2,150	-2004000301	(+)	-2004000302	(+)
40x40x2,0	40,0	40,0	2,0			2,454	-2004000401	(+)	-2004000402	(+)
50x20x2,0	50,0	20,0	2,0			2,150	-2005000201	(+)	-2005000202	(+)
50x25x2,0	50,0	25,0	2,0			2,319	-2005000251	(+)	-2005000252	(+)
50x30x2,0	50,0	30,0	2,0			2,454	-2005000301	(+)	-2005000302	(+)
50x50x2,0	50,0	50,0	2,0			3,080	-2005000501	(+)	-2005000502	(+)
60x30x2,0	60,0	30,0	2,0			2,804	-2006000301	(+)	-2006000302	(+)
60x40x2,0	60,0	40,0	2,0			3,080	-2006000401	(+)	-2006000402	(+)
60x60x2,0	60,0	60,0	2,0			3,711	-2006000601	(+)	-2006000602	(+)
80x40x2,0	80,0	40,0	2,0			3,711	-2008000401	(+)	-2008000402	(+)
80x60x2,0	80,0	60,0	2,0			4,380	-2008000601	(+)	-2008000602	(+)
80x80x2,0	80,0	80,0	2,0			4,988	-2008000801	(+)	-2008000802	(+)
100x40x2,0	100,0	40,0	2,0			4,380	-2010000401	(+)	-2010000402	(+)
100x50x2,0	100,0	50,0	2,0			4,680	-2010000501	(+)	-2010000502	(+)
100x60x2,0	100,0	60,0	2,0			4,960	-2010000601	(+)	-2010000602	(+)
100x100x2,0	100,0	100,0	2,0			6,400	-2010001001	(+)	-2010001002	(+)
30x30x3,0	30,0	30,0	3,0			2,720	-3003000301	(+)	-3003000302	(+)
40x40x3,0	40,0	40,0	3,0			3,756	-3004000401	(+)	-3004000402	(+)
50x30x3,0	50,0	30,0	3,0			3,756	-3005000301	(+)	-3005000302	(+)
50x50x3,0	50,0	50,0	3,0			4,650	-3005000501	(+)	-3005000502	(+)
60x40x3,0	60,0	40,0	3,0			4,650	-3006000401	(+)	-3006000402	(+)
60x60x3,0	60,0	60,0	3,0			5,491	-3006000601	(+)	-3006000602	(+)
80x40x3,0	80,0	40,0	3,0			5,491	-3008000401	(+)	-3008000402	(+)
80x60x3,0	80,0	60,0	3,0			6,530	-3008000601	(+)	-3008000602	(+)
80x80x3,0	80,0	80,0	3,0			7,530	-3008000801	(+)	-3008000802	(+)
100x40x3,0	100,0	40,0	3,0			6,530	-3010000401	(+)	-3010000402	(+)
100x50x3,0	100,0	50,0	3,0			6,864	-3010000501	(+)	-3010000502	(+)
100x60x3,0	100,0	60,0	3,0			7,344	-3010000601	(+)	-3010000602	(+)
100x80x3,0	100,0	80,0	3,0			8,304	-3010000801	(+)	-3010000802	(+)
100x100x3,0	100,0	80,0	3,0			9,530	-3010001001	(+)	-3010001002	(+)

Vierkant/
Rechteckrohr
geschweißt

square/rectangle
pipe
welded

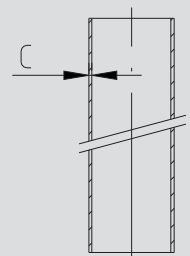
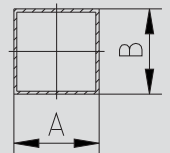

(+) Preis auf Anfrage

(+) price on inquiry

8.04 Vierkantrohr AISI 316L
8.04 square/rectangle pipe AISI 316L

Vierkant-/ Rechteckrohr geschweißt square/rectangle pipe welded	Art.-Nr. 81-							AISI 316 L-1.4404			
	DN	A	B	C	D	E	Gew.	Art.-Nr. geschliffen	Preis EUR	Art.-Nr. matt	Preis EUR
	mm	mm	mm	mm	mm	kg/m					
	15x15x1,5	15,0	15,0	1,5			0,660	-1501500153	(+)	-1501500154	(+)
	20x10x1,5	20,0	10,0	1,5			0,660	-1502000103	(+)	-1502000104	(+)
	20x20x1,5	20,0	20,0	1,5			0,883	-1502000203	(+)	-1502000204	(+)
	25x15x1,5	25,0	15,0	1,5			0,883	-1502500153	(+)	-1502500154	(+)
	25x25x1,5	25,0	25,0	1,5			1,146	-1502500253	(+)	-1502500254	(+)
	30x15x1,5	30,0	15,0	1,5			0,995	-1503000153	(+)	-1503000154	(+)
	30x20x1,5	30,0	20,0	1,5			1,146	-1503000203	(+)	-1503000204	(+)
	30x30x1,5	30,0	30,0	1,5			1,371	-1503000303	(+)	-1503000304	(+)
	40x20x1,5	40,0	20,0	1,5			1,371	-1504000203	(+)	-1504000204	(+)
	40x30x1,5	40,0	30,0	1,5			1,620	-1504000303	(+)	-1504000304	(+)
	40x40x1,5	40,0	40,0	1,5			1,859	-1504000403	(+)	-1504000404	(+)
	50x25x1,5	50,0	25,0	1,5			1,758	-1505000253	(+)	-1505000254	(+)
	50x30x1,5	50,0	30,0	1,5			1,859	-1505000303	(+)	-1505000304	(+)
	50x50x1,5	50,0	50,0	1,5			2,329	-1505000503	(+)	-1505000504	(+)
	60x30x1,5	60,0	30,0	1,5			2,122	-1506000303	(+)	-1506000304	(+)
	60x40x1,5	60,0	40,0	1,5			2,329	-1506000403	(+)	-1506000404	(+)
	20x20x2,0	20,0	20,0	2,0			1,152	-2002000203	(+)	-2002000204	(+)
	25x25x2,0	25,0	25,0	2,0			1,495	-2002500253	(+)	-2002500254	(+)
	30x20x2,0	30,0	20,0	2,0			1,495	-2003000203	(+)	-2003000204	(+)
	30x30x2,0	30,0	30,0	2,0			1,840	-2003000303	(+)	-2003000304	(+)
	35x35x2,0	35,0	35,0	2,0			2,150	-2003500353	(+)	-2003500354	(+)
	40x20x2,0	40,0	20,0	2,0			1,840	-2004000203	(+)	-2004000204	(+)
	40x30x2,0	40,0	30,0	2,0			2,150	-2004000303	(+)	-2004000304	(+)
	40x40x2,0	40,0	40,0	2,0			2,454	-2004000403	(+)	-2004000404	(+)
	50x20x2,0	50,0	20,0	2,0			2,150	-2005000203	(+)	-2005000204	(+)
	50x25x2,0	50,0	25,0	2,0			2,319	-2005000253	(+)	-2005000254	(+)
	50x30x2,0	50,0	30,0	2,0			2,454	-2005000303	(+)	-2005000304	(+)
	50x50x2,0	50,0	50,0	2,0			3,080	-2005000503	(+)	-2005000504	(+)
	60x30x2,0	60,0	30,0	2,0			2,804	-2006000303	(+)	-2006000304	(+)
	60x40x2,0	60,0	40,0	2,0			3,080	-2006000403	(+)	-2006000404	(+)
	60x60x2,0	60,0	60,0	2,0			3,711	-2006000603	(+)	-2006000604	(+)
	80x40x2,0	80,0	40,0	2,0			3,711	-2008000403	(+)	-2008000404	(+)
	80x60x2,0	80,0	60,0	2,0			4,380	-2008000603	(+)	-2008000604	(+)
	80x80x2,0	80,0	80,0	2,0			4,988	-2008000803	(+)	-2008000804	(+)
	100x40x2,0	100,0	40,0	2,0			4,380	-2010000403	(+)	-2010000404	(+)
	100x50x2,0	100,0	50,0	2,0			4,680	-2010000503	(+)	-2010000504	(+)
	100x60x2,0	100,0	60,0	2,0			4,960	-2010000603	(+)	-2010000604	(+)
	100x100x2,0	100,0	100,0	2,0			6,400	-2010001003	(+)	-2010001004	(+)
	30x30x3,0	30,0	30,0	3,0			2,720	-3003000303	(+)	-3003000304	(+)
	40x40x3,0	40,0	40,0	3,0			3,756	-3004000403	(+)	-3004000404	(+)
	50x30x3,0	50,0	30,0	3,0			3,756	-3005000303	(+)	-3005000304	(+)
	50x50x3,0	50,0	50,0	3,0			4,650	-3005000503	(+)	-3005000504	(+)
	60x40x3,0	60,0	40,0	3,0			4,650	-3006000403	(+)	-3006000404	(+)
	60x60x3,0	60,0	60,0	3,0			5,491	-3006000603	(+)	-3006000604	(+)
	80x40x3,0	80,0	40,0	3,0			5,491	-3008000403	(+)	-3008000404	(+)
	80x60x3,0	80,0	60,0	3,0			6,530	-3008000603	(+)	-3008000604	(+)
	80x80x3,0	80,0	80,0	3,0			7,530	-3008000803	(+)	-3008000804	(+)
	100x40x3,0	100,0	40,0	3,0			6,530	-3010000403	(+)	-3010000404	(+)
	100x50x3,0	100,0	50,0	3,0			6,864	-3010000503	(+)	-3010000504	(+)
	100x60x3,0	100,0	60,0	3,0			7,344	-3010000603	(+)	-3010000604	(+)
	100x80x3,0	100,0	80,0	3,0			8,304	-3010000803	(+)	-3010000804	(+)
	100x100x3,0	100,0	100,0	3,0			9,530	-3010001003	(+)	-3010001004	(+)

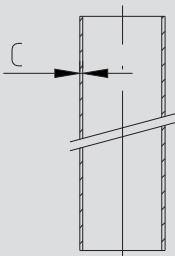
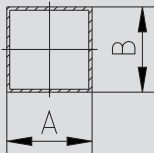

(+) Preis auf Anfrage

(+) price on inquiry



Armaturen GmbH

fon + 49 (0) 44 65 8 07 0
fax + 49 (0) 44 65 8 07 40



Armaturen GmbH

Armaturen, Rohre, Sonderteile aus Edelstahl
fittings, pipes, special parts of stainless steel

Industriestraße 24 - 26 · D-26446 Friedeburg
fon + 49 (0) 44 65 8 07 0 · fax + 49 (0) 44 65 8 07 40
mail: info@ms-armaturen.de · <http://www.ms-armaturen.de>