



Armaturen GmbH

Armaturen, Rohre, Sonderteile aus Edelstahl
fittings, pipes, special parts of stainless steel

T-Stücke und T-Bogen
tees and tee bends



Armaturen GmbH

fon + 49 (0) 44 65 8 07 0
fax + 49 (0) 44 65 8 07 40



Armaturen GmbH

fon: + 49 (0) 44 65 8 07 0
fax: + 49 (0) 44 65 8 07 40

4 T-Stücke und T-Bogen
4 tees and tee bends



Die Ergänzung unseres Maschinenparks ermöglicht uns nun auch die Fertigung von Verteilerrohren bis zu einer Gesamtlänge von 6 m aus einem Stück. Damit hoffen wir, Ihnen neue Möglichkeiten bei der Realisierung mancher Projekte bieten zu können.

Beachten Sie auch die T-Stücke höchster Oberflächengüte aus unserem PharmCom- und HyCom-Programm in Produktgruppe 10!

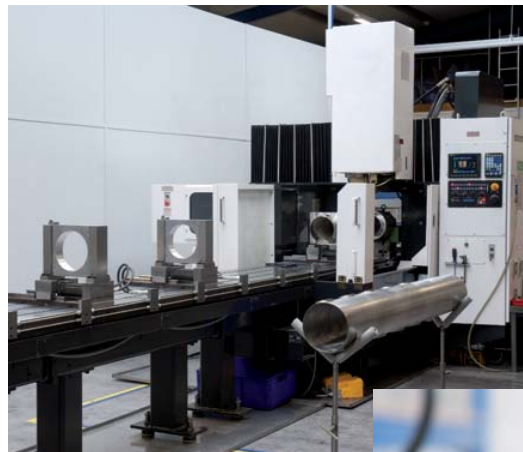

Rohrbearbeitungszentrum
Tube processing centre



Rohrbearbeitung
Tube processing

The extension of our machinery makes it now possible to manufacture manifolds up to a total length of 6m and in one piece. With this new innovation, we hope to offer you new possibilities to realize your projects.

Please take a look at our tees of highest surface finish from our PharmCom- and HyCom-programme in product group 10.

4.01 T-Stück kurz
4.01 welding tee short

Art.-Nr. 41110-							AISI 304/304L-1.4301/1.4307				AISI 316L-1.4404			
DN	A	B	C	D	E	Gew.	Art.-Nr.	Preis	Art.-Nr.	Preis	Art.-Nr.	Preis	Art.-Nr.	Preis
mm	mm	mm	mm	mm	mm	kg	poliert	EUR	matt	EUR	poliert	EUR	matt	EUR
10	26,0	9,0	12,0	7,0		0,015	-0101	12,50	-0102	10,90	-0103	14,80	-0104	12,45
15	35,0	15,0	18,0	10,0		0,030	-0151	11,25	-0152	9,65	-0153	14,25	-0154	11,35
20	40,0	19,0	22,0	12,0		0,050	-0201	10,60	-0202	9,30	-0203	13,70	-0204	10,90
25	50,0	25,0	28,0	16,0		0,080	-0251	9,50	-0252	7,65	-0253	12,40	-0254	9,50
32	55,0	31,0	34,0	19,0		0,110	-0321	11,00	-0322	9,30	-0323	13,15	-0324	10,95
40	60,0	37,0	40,0	22,5		0,150	-0401	11,70	-0402	9,20	-0403	15,05	-0404	12,10
50	70,0	49,0	52,0	29,5		0,240	-0501	13,70	-0502	10,25	-0503	17,80	-0504	14,10
65	80,0	66,0	70,0	40,0		0,480	-0651	19,40	-0652	15,45	-0653	23,60	-0654	19,05
80	90,0	81,0	85,0	47,5		0,650	-0801	25,15	-0802	19,80	-0803	31,65	-0804	27,20
100	100,0	100,0	104,0	58,0		0,910	-1001	35,05	-1002	26,95	-1003	42,90	-1004	36,95
125	187,5	125,0	129,0	71,5		2,160	-1251	100,75	-1252	75,30	-1253	117,50	-1254	96,10
150	225,0	150,0	154,0	87,0		3,020	-1501	136,65	-1502	106,35	-1503	170,35	-1504	138,55
200	300,0	200,0	204,0	111,0		5,550	-2001	234,30	-2002	201,60	-2003	263,50	-2004	230,80
250	375,0	250,0	254,0	141,0		8,500	-2501	276,50	-2502	243,50	-2503	312,05	-2504	279,15

DN65-200 gem. DIN 11852-TK

DN65-200 acc. DIN 11852-TK

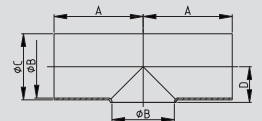
T-Stück SSS kurz
**welding tee
DIN short**

Art.-Nr. 41111-							AISI 304/304L-1.4301/1.4307				AISI 316L-1.4404			
DN	A	B	C	D	E	Gew.	Art.-Nr.	Preis	Art.-Nr.	Preis	Art.-Nr.	Preis	Art.-Nr.	Preis
mm	mm	mm	mm	mm	mm	kg	poliert	EUR	matt	EUR	poliert	EUR	matt	EUR
1"	50,0	22,9	25,4	14,0		0,060	-1001	10,70	-1002	8,75	-1003	13,65	-1004	10,80
1,5"	60,0	35,1	38,1	20,0		0,140	-1121	12,85	-1122	10,10	-1123	16,40	-1124	13,55
2"	70,0	47,8	50,8	27,5		0,230	-2001	14,75	-2002	11,15	-2003	18,75	-2004	15,35
2,5"	80,0	60,2	63,5	36,0		0,340	-2121	20,40	-2122	16,25	-2123	24,75	-2124	20,15
3"	90,0	72,8	76,1	44,0		0,620	-3001	27,55	-3002	22,30	-3003	34,95	-3004	29,85
4"	100,0	97,4	101,6	56,0		0,890	-4001	38,15	-4002	29,90	-4003	47,95	-4004	40,60

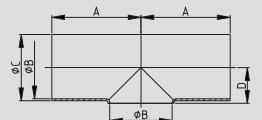
T-Stück SSS kurz
**welding tee
inch short**

Art.-Nr. 41112-							AISI 304/304L-1.4301/1.4307				AISI 316L-1.4404			
DN	A	B	C	D	E	Gew.	Art.-Nr.	Preis	Art.-Nr.	Preis	Art.-Nr.	Preis	Art.-Nr.	Preis
mm	mm	mm	mm	mm	mm	kg	poliert	EUR	matt	EUR	poliert	EUR	matt	EUR
10	26,0	10,0	13,0	7,5		0,015					-0103	(+)	-0104	(+)
15	35,0	16,0	19,0	11,0		0,030	-0151	11,75	-0152	10,15	-0153	14,85	-0154	11,95
20	40,0	20,0	23	13,0		0,050	-0201	11,10	-0202	9,80	-0203	14,25	-0204	11,45
25	50,0	26,0	29,0	16,0		0,080	-0251	9,90	-0252	8,05	-0253	12,90	-0254	10,00
32	55,0	32,0	35,0	19,5		0,110	-0321	11,50	-0322	9,80	-0323	13,70	-0324	11,50
40	60,0	38,0	41,0	23,0		0,150	-0401	12,20	-0402	9,70	-0403	15,70	-0404	12,75
50	70,0	50,0	53,0	30,0		0,240	-0501	14,25	-0502	10,80	-0503	18,55	-0504	14,85

DN65-200 siehe Art.-Nr. 41110

DN65-200 see item-no. 41110

(+) Preis auf Anfrage

(+) price on inquiry

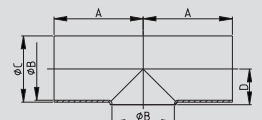
**T-Stück
DIN 11852-TK**
**welding tee
DIN 11852-TK**

4.02 T-Stück lang

4.02 welding tee long

T-Stück SSS lang welding tee DIN long		Art.-Nr. 42220-						AISI 304/304L-1.4301/1.4307				AISI 316L-1.4404				
		DN	A	B	C	D	E	Gew.	Art.-Nr.	Preis	Art.-Nr.	Preis	Art.-Nr.	Preis	Art.-Nr.	Preis
		mm	mm	mm	mm	mm	mm	kg	poliert	EUR	matt	EUR	poliert	EUR	matt	EUR
10	26,0	9,0	12,0				0,020	-0101	16,10	-0102	12,95	-0103	22,20	-0104	19,15	
15	35,0	15,0	18,0				0,050	-0151	18,10	-0152	14,65	-0153	25,10	-0154	21,75	
20	40,0	19,0	22,0				0,090	-0201	15,20	-0202	12,30	-0203	19,70	-0204	17,00	
25	50,0	25,0	28,0				0,110	-0251	13,60	-0252	10,50	-0253	17,40	-0254	15,10	
32	55,0	31,0	34,0				0,150	-0321	15,00	-0322	11,80	-0323	20,05	-0324	17,25	
40	60,0	37,0	40,0				0,210	-0401	16,95	-0402	12,70	-0403	21,80	-0404	19,20	
50	70,0	49,0	52,0				0,310	-0501	21,60	-0502	15,60	-0503	28,40	-0504	24,10	
65	80,0	66,0	70,0				0,630	-0651	30,65	-0652	22,20	-0653	40,25	-0654	34,00	
80	90,0	81,0	85,0				0,870	-0801	37,65	-0802	29,10	-0803	50,35	-0804	41,85	
100	100,0	100,0	104,0				1,060	-1001	54,00	-1002	38,90	-1003	70,00	-1004	58,95	
125	187,5	125,0	129,0				2,840	-1251	159,50	-1252	132,95	-1253	179,05	-1254	164,75	
150	225,0	150,0	154,0				3,880	-1501	231,25	-1502	179,35	-1503	254,75	-1504	216,15	
200	300,0	200,0	204,0				9,950	-2001	345,10	-2002	265,20	-2003	424,35	-2004	345,10	
250	375,0	254,0	250,0				10,500	-2501	402,30	-2502	314,80	-2503	485,10	-2504	407,30	
DN65-200 gem. DIN 11852-TS								DN65-200 acc. DIN 11852-TS								

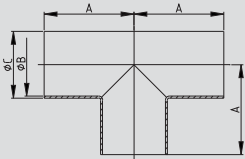

T-Stück SSS lang (Zoll) welding tee inch long		Art.-Nr. 42221-						AISI 304/304L-1.4301/1.4307				AISI 316L-1.4404				
		DN	A	B	C	D	E	Gew.	Art.-Nr.	Preis	Art.-Nr.	Preis	Art.-Nr.	Preis	Art.-Nr.	Preis
		mm	mm	mm	mm	mm	mm	kg	poliert	EUR	matt	EUR	poliert	EUR	matt	EUR
1"	50,0	22,9	25,4				0,090	-1001	14,90	-1002	11,90	-1003	19,60	-1004	16,55	
1,5"	60,0	35,1	38,1				0,165	-1121	18,60	-1122	14,00	-1123	23,65	-1124	20,85	
2"	70,0	47,8	50,8				0,330	-2001	23,15	-2002	17,30	-2003	30,85	-2004	26,10	
2,5"	80,0	60,2	63,5				0,400	-2121	31,45	-2122	22,90	-2123	41,75	-2124	34,50	
3"	90,0	72,8	76,1				0,540	-3001	40,00	-3002	32,45	-3003	55,65	-3004	46,00	
4"	100,0	97,4	101,6				1,010	-4001	56,75	-4002	40,85	-4003	72,70	-4004	62,75	

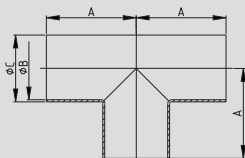

T-Stück DIN 11852-TS welding tee DIN 11852-TS		Art.-Nr. 42222-						AISI 304/304L-1.4301/1.4307				AISI 316L-1.4404				
		DN	A	B	C	D	E	Gew.	Art.-Nr.	Preis	Art.-Nr.	Preis	Art.-Nr.	Preis	Art.-Nr.	Preis
		mm	mm	mm	mm	mm	mm	kg	poliert	EUR	matt	EUR	poliert	EUR	matt	EUR
10	26,0	10,0	13,0				0,020					-0103	23,20	-0104	20,15	
15	35,0	16,0	19,0				0,050	-0151	18,85	-0152	15,40	-0153	26,20	-0154	22,85	
20	40,0	20,0	23,0				0,090	-0201	15,85	-0202	12,95	-0203	20,55	-0204	17,85	
25	50,0	26,0	29,0				0,110	-0251	14,15	-0252	11,05	-0253	18,20	-0254	15,90	
32	55,0	32,0	35,0				0,150	-0321	15,60	-0322	12,40	-0323	20,95	-0324	18,15	
40	60,0	38,0	41,0				0,210	-0401	17,60	-0402	13,35	-0403	22,80	-0404	20,20	
50	70,0	50,0	53,0				0,310	-0501	22,40	-0502	16,40	-0503	29,65	-0504	25,30	
DN65-200 siehe Art.-Nr. 42220								DN65-200 see item-no. 42220								

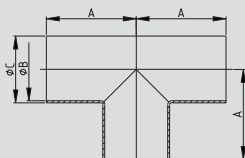

4.03 Red-T-Stück kurz
4.03 reduced welding tee short

Art.-Nr. 42270-							AISI 304/304L-1.4301/1.4307				AISI 316L-1.4404			
DN	A	B	C	D	E	Gew.	Art.-Nr.	Preis	Art.-Nr.	Preis	Art.-Nr.	Preis	Art.-Nr.	Preis
mm	mm	mm	mm	mm	mm	kg	poliert	EUR	matt	EUR	poliert	EUR	matt	EUR
15-10	35,0	15,0	18,0	10,0	9,0	0,040	-0151010	19,15	-0152010	16,80	-0153010	28,00	-0154010	27,15
20-10	40,0	19,0	22,0	12,0	9,0	0,070	-0201010	20,05	-0202010	18,00	-0203010	16,05	-0204010	26,95
20-15	40,0	19,0	22,0	12,0	15,0	0,060	-0201015	18,00	-0202015	16,05	-0203015	26,95	-0204015	26,15
25-10	50,0	25,0	28,0	16,0	9,0	0,110	-0251010	14,60	-0252010	12,20	-0253010	26,10	-0254010	24,20
25-15	50,0	25,0	28,0	16,0	15,0	0,100	-0251015	14,60	-0252015	13,05	-0253015	21,90	-0254015	21,20
25-20	50,0	25,0	28,0	16,0	19,0	0,090	-0251020	12,20	-0252020	10,60	-0253020	18,30	-0254020	17,25
32-15	55,0	31,0	34,0	20,5	15,0	0,130	-0321015	16,85	-0322015	14,50	-0323015	24,90	-0324015	23,20
32-20	55,0	31,0	34,0	20,5	19,0	0,130	-0321020	15,90	-0322020	13,55	-0323020	23,40	-0324020	21,70
32-25	55,0	31,0	34,0	20,5	25,0	0,130	-0321025	13,75	-0322025	11,15	-0323025	20,45	-0324025	17,95
40-15	60,0	37,0	40,0	23,0	15,0	0,160	-0401015	18,35	-0402015	15,65	-0403015	27,35	-0404015	24,85
40-20	60,0	37,0	40,0	23,0	19,0	0,160	-0401020	17,65	-0402020	14,90	-0403020	26,30	-0404020	23,70
40-25	60,0	37,0	40,0	23,0	25,0	0,160	-0401025	15,55	-0402025	12,75	-0403025	23,40	-0404025	20,60
40-32	60,0	37,0	40,0	23,0	31,0	0,150	-0401032	16,10	-0402032	13,10	-0403032	24,15	-0404032	21,15
50-20	70,0	49,0	52,0	29,0	19,0	0,260	-0501020	19,15	-0502020	15,75	-0503020	29,00	-0504020	25,80
50-25	70,0	49,0	52,0	29,0	25,0	0,240	-0501025	17,50	-0502025	14,10	-0503025	26,50	-0504025	23,15
50-32	70,0	49,0	52,0	29,0	31,0	0,250	-0501032	17,80	-0502032	14,35	-0503032	26,65	-0504032	23,30
50-40	70,0	49,0	52,0	29,0	37,0	0,230	-0501040	17,80	-0502040	14,35	-0503040	26,65	-0504040	23,30
65-25	80,0	66,0	70,0	39,0	25,0	0,520	-0651025	24,90	-0652025	20,10	-0653025	37,05	-0654025	32,70
65-32	80,0	66,0	70,0	39,0	31,0	0,520	-0651032	24,90	-0652032	20,10	-0653032	37,05	-0654032	32,70
65-40	80,0	66,0	70,0	39,0	37,0	0,510	-0651040	24,95	-0652040	20,20	-0653040	37,20	-0654040	32,90
65-50	80,0	66,0	70,0	39,0	49,0	0,520	-0651050	25,05	-0652050	20,25	-0653050	37,45	-0654050	32,85
80-25	90,0	81,0	85,0	47,0	25,0	0,720	-0801025	31,80	-0802025	25,35	-0803025	47,30	-0804025	41,00
80-32	90,0	81,0	85,0	47,0	31,0	0,700	-0801032	31,80	-0802032	25,35	-0803032	47,30	-0804032	41,00
80-40	90,0	81,0	85,0	47,0	37,0	0,700	-0801040	31,80	-0802040	25,35	-0803040	47,30	-0804040	41,00
80-50	90,0	81,0	85,0	47,0	49,0	0,690	-0801050	31,85	-0802050	25,55	-0803050	47,65	-0804050	41,50
80-65	90,0	81,0	85,0	47,0	66,0	0,680	-0801065	32,60	-0802065	26,15	-0803065	49,15	-0804065	42,90
100-25	100,0	100,0	104,0	58,0	25,0	0,960	-1001025	39,50	-1002025	31,70	-1003025	58,75	-1004025	51,30
100-32	100,0	100,0	104,0	58,0	31,0	0,960	-1001032	39,50	-1002032	31,70	-1003032	58,75	-1004032	51,30
100-40	100,0	100,0	104,0	58,0	37,0	0,950	-1001040	39,50	-1002040	31,70	-1003040	58,75	-1004040	51,30
100-50	100,0	100,0	104,0	58,0	49,0	0,940	-1001050	39,75	-1002050	32,15	-1003050	59,40	-1004050	52,00
100-65	100,0	100,0	104,0	58,0	66,0	0,950	-1001065	41,20	-1002065	33,25	-1003065	61,60	-1004065	53,80
100-80	100,0	100,0	104,0	58,0	81,0	0,950	-1001080	41,90	-1002080	33,95	-1003080	62,95	-1004080	55,20
125-25	187,5	125,0	129,0	71,5	25,0	2,220	-1251025	134,30	-1252025	103,30	-1253025	201,40	-1254025	168,35
125-32	187,5	125,0	129,0	71,5	31,0	2,210	-1251032	136,60	-1252032	105,65	-1253032	204,95	-1254032	172,20
125-40	187,5	125,0	129,0	71,5	37,0	2,250	-1251040	138,00	-1252040	107,05	-1253040	207,05	-1254040	174,45
125-50	187,5	125,0	129,0	71,5	49,0	2,240	-1251050	139,45	-1252050	108,50	-1253050	209,15	-1254050	176,75
125-65	187,5	125,0	129,0	71,5	66,0	2,160	-1251065	140,40	-1252065	109,40	-1253065	210,50	-1254065	178,25
125-80	187,5	125,0	129,0	71,5	81,0	2,170	-1251080	142,75	-1252080	111,75	-1253080	214,05	-1254080	182,10
125-100	187,5	125,0	129,0	71,5	100,0	2,140	-1251100	144,10	-1252100	113,15	-1253100	216,15	-1254100	184,40
150-40	225,0	150,0	154,0	87,0	37,0	3,220	-1501040	199,00	-1502040	162,75	-1503040	298,55	-1504040	265,20
150-50	225,0	150,0	154,0	87,0	49,0	3,180	-1501050	200,45	-1502050	164,10	-1503050	300,60	-1504050	267,45
150-65	225,0	150,0	154,0	87,0	66,0	3,160	-1501065	202,25	-1502065	165,95	-1503065	303,35	-1504065	270,45
150-80	225,0	150,0	154,0	87,0	81,0	3,170	-1501080	203,65	-1502080	167,30	-1503080	305,45	-1504080	272,70
150-100	225,0	150,0	154,0	87,0	100,0	3,140	-1501100	205,05	-1502100	168,70	-1503100	307,50	-1504100	274,95
150-125	225,0	150,0	154,0	87,0	125,0	3,070	-1501125	206,40	-1502125	170,10	-1503125	309,55	-1504125	277,20
200-125	300,0	200,0	204,0	110,0	125,0	5,680	-2001125	(+)	-2002125	(+)	-2003125	(+)	-2004125	(+)
200-150	300,0	200,0	204,0	110,0	150,0	5,400	-2001150	(+)	-2002150	(+)	-2003150	(+)	-2004150	(+)
250-150	375,0	250,0	254,0	141,0	150,0	8,800	-2501150	(+)	-2502150	(+)	-2503150	(+)	-2504150	(+)
250-200	375,0	250,0	254,0	141,0	200,0	8,820	-2501200	(+)	-2502200	(+)	-2503200	(+)	-2504200	(+)

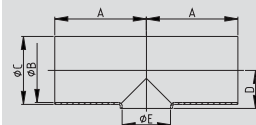
**Red-T-Stück
SSS kurz**
**reduced welding tee
DIN short**

(+) Preis auf Anfrage

(+) price on inquiry

4.04 Red-T-Stück kurz

4.04 reduced welding tee short

Red-T-Stück ähnl. DIN 11852-TK reduced welding tee sim. DIN 11852-TK	Art.-Nr. 42272-							AISI 304/304L-1.4301/1.4307				AISI 316L-1.4404			
	DN	A	B	C	D	E	Gew.	Art.-Nr.	Preis	Art.-Nr.	Preis	Art.-Nr.	Preis	Art.-Nr.	Preis
		mm	mm	mm	mm	mm	kg	poliert	EUR	matt	EUR	poliert	EUR	matt	EUR
	15-10	35,0	16,0	19,0	10,5	10,0	0,040	-0151010	25,30	-0152010	23,90	-0153010	33,10	-0154010	30,80
	20-10	40,0	20,0	23,0	13,0	10,0	0,070	-0201010	25,30	-0202010	23,90	-0203010	38,05	-0204010	35,45
	20-15	40,0	20,0	23,0	13,0	16,0	0,060	-0201015	22,00	-0202015	20,75	-0203015	33,10	-0204015	30,80
	25-10	50,0	26,0	29,0	16,0	10,0	0,110	-0251010	29,00	-0252010	32,15	-0253010	43,40	-0254010	39,15
	25-15	50,0	26,0	29,0	16,5	16,0	0,100	-0251015	18,05	-0252015	16,20	-0253015	27,40	-0254015	24,50
	25-20	50,0	26,0	29,0	16,0	20,0	0,090	-0251020	15,70	-0252020	14,20	-0253020	23,85	-0254020	22,30
	32-15	55,0	32,0	35,0	19,5	16,0	0,130	-0321015	21,30	-0322015	18,90	-0323015	28,95	-0324015	26,80
	32-20	55,0	32,0	35,0	19,5	20,0	0,130	-0321020	20,15	-0322020	17,70	-0323020	27,30	-0324020	25,15
	32-25	55,0	32,0	35,0	19,0	26,0	0,130	-0321025	17,55	-0322025	15,25	-0323025	22,40	-0324025	19,65
	40-20	60,0	38,0	41,0	23,0	20,0	0,160	-0401020	20,70	-0402020	17,05	-0403020	30,45	-0404020	26,65
	40-25	60,0	38,0	41,0	23,0	26,0	0,160	-0401025	18,35	-0402025	14,65	-0403025	27,40	-0404025	23,15
	40-32	60,0	38,0	41,0	23,0	32,0	0,150	-0401032	18,95	-0402032	15,15	-0403032	28,35	-0404032	27,10
	50-25	70,0	50,0	53,0	30,0	26,0	0,240	-0501025	20,70	-0502025	15,30	-0503025	31,30	-0504025	25,80
	50-32	70,0	50,0	53,0	30,0	32,0	0,250	-0501032	21,05	-0502032	15,55	-0503032	31,10	-0504032	25,75
	50-40	70,0	50,0	53,0	30,0	38,0	0,230	-0501040	21,05	-0502040	15,55	-0503040	31,10	-0504040	25,75
	65-25	80,0	66,0	70,0	38,0	26,0	0,520	-0651025	33,60	-0652025	27,10	-0653025	50,00	-0654025	44,10
	65-32	80,0	66,0	70,0	38,0	32,0	0,520	-0651032	33,60	-0652032	27,10	-0653032	50,00	-0654032	44,10
	65-40	80,0	66,0	70,0	38,0	38,0	0,510	-0651040	33,65	-0652040	27,25	-0653040	50,20	-0654040	44,40
	65-50	80,0	66,0	70,0	38,0	50,0	0,520	-0651050	33,80	-0652050	27,35	-0653050	50,55	-0654050	44,35
	80-25	90,0	81,0	85,0	47,5	26,0	0,720	-0801025	42,95	-0802025	34,25	-0803025	63,85	-0804025	55,30
	80-32	90,0	81,0	85,0	47,5	32,0	0,700	-0801032	42,95	-0802032	34,25	-0803032	63,85	-0804032	55,30
	80-40	90,0	81,0	85,0	47,5	38,0	0,700	-0801040	42,95	-0802040	34,25	-0803040	63,85	-0804040	55,30
	80-50	90,0	81,0	85,0	47,5	50,0	0,690	-0801050	43,05	-0802050	34,50	-0803050	64,30	-0804050	56,00
	100-25	100,0	100,0	104,0	58,0	26,0	0,960	-1001025	53,30	-1002025	42,80	-1003025	79,30	-1004025	69,25
	100-32	100,0	100,0	104,0	58,0	32,0	0,960	-1001032	53,30	-1002032	42,80	-1003032	79,30	-1004032	69,25
	100-40	100,0	100,0	104,0	58,0	38,0	0,950	-1001040	53,30	-1002040	42,80	-1003040	79,30	-1004040	69,25
	100-50	100,0	100,0	104,0	58,0	50,0	0,940	-1001050	53,65	-1002050	43,45	-1003050	80,15	-1004050	70,20
	125-25	187,5	125,0	129,0	72,5	26,0	2,220	-1251025	181,30	-1252025	139,50	-1253025	271,90	-1254025	227,30
	125-32	187,5	125,0	129,0	72,5	32,0	2,210	-1251032	184,40	-1252032	142,60	-1253032	276,65	-1254032	232,45
	125-40	187,5	125,0	129,0	72,5	38,0	2,250	-1251040	186,35	-1252040	144,50	-1253040	279,50	-1254040	235,50
	125-50	187,5	125,0	129,0	72,5	50,0	2,240	-1251050	188,25	-1252050	146,45	-1253050	282,35	-1254050	238,60
	150-40	225,0	150,0	154,0	87,0	38,0	3,220	-1501040	268,70	-1502040	219,70	-1503040	403,05	-1504040	358,05
	150-50	225,0	150,0	154,0	87,0	50,0	3,180	-1501050	270,65	-1502050	221,50	-1503050	405,85	-1504050	361,05

4.05 Red-T-Stück lang
4.05 reduced welding tee long

Art.-Nr. 42280-							AISI 304/304L-1.4301/1.4307				AISI 316L-1.4404			
DN	A	B	C	D	E	Gew.	Art.-Nr.	Preis	Art.-Nr.	Preis	Art.-Nr.	Preis	Art.-Nr.	Preis
mm	mm	mm	mm	mm	mm	kg	poliert	EUR	matt	EUR	poliert	EUR	matt	EUR
15-10	35,0	29,0	18,0	15,0	12,0	0,050	-0151010	23,80	-0152010	21,20	-0153010	35,65	-0154010	34,50
20-10	40,0	31,0	22,0	19,0	12,0	0,080	-0201010	23,15	-0202010	20,75	-0203010	34,70	-0204010	33,85
20-15	40,0	37,5	22,0	19,0	18,0	0,080	-0201015	22,45	-0202015	20,05	-0203015	33,65	-0204015	32,65
25-10	50,0	35,0	28,0	25,0	12,0	0,100	-0251010	19,30	-0252010	17,20	-0253010	28,95	-0254010	27,95
25-15	50,0	40,0	28,0	25,0	18,0	0,100	-0251015	18,80	-0252015	15,50	-0253015	26,10	-0254015	25,25
25-20	50,0	42,0	28,0	25,0	22,0	0,100	-0251020	17,75	-0252020	14,40	-0253020	21,80	-0254020	20,50
32-15	55,0	44,0	34,0	31,0	18,0	0,150	-0321015	20,40	-0322015	17,55	-0323015	30,65	-0324015	28,55
32-20	55,0	46,0	34,0	31,0	22,0	0,150	-0321020	19,20	-0322020	16,35	-0323020	28,80	-0324020	26,65
32-25	55,0	54,0	34,0	31,0	28,0	0,150	-0321025	19,35	-0322025	15,10	-0323025	25,05	-0324025	22,00
40-15	60,0	48,0	40,0	37,0	18,0	0,160	-0401015	21,70	-0402015	18,15	-0403015	32,50	-0404015	29,60
40-20	60,0	50,0	40,0	37,0	22,0	0,160	-0401020	20,90	-0402020	17,35	-0403020	31,35	-0404020	28,20
40-25	60,0	58,0	40,0	37,0	28,0	0,180	-0401025	19,80	-0402025	14,85	-0403025	27,55	-0404025	24,25
40-32	60,0	60,0	40,0	37,0	34,0	0,200	-0401032	19,95	-0402032	15,55	-0403032	28,90	-0404032	25,30
50-20	70,0	56,5	52,0	49,0	22,0	0,250	-0501020	23,35	-0502020	18,70	-0503020	34,15	-0504020	30,40
50-25	70,0	65,0	52,0	49,0	28,0	0,270	-0501025	22,40	-0502025	16,70	-0503025	31,25	-0504025	27,20
50-32	70,0	68,0	52,0	49,0	34,0	0,270	-0501032	22,75	-0502032	16,90	-0503032	31,30	-0504032	27,45
50-40	70,0	70,0	52,0	49,0	40,0	0,310	-0501040	23,05	-0502040	18,05	-0503040	32,40	-0504040	28,05
65-25	80,0	74,0	70,0	66,0	28,0	0,500	-0651025	31,50	-0652025	25,40	-0653025	47,25	-0654025	36,05
65-32	80,0	76,0	70,0	66,0	34,0	0,500	-0651032	31,50	-0652032	25,40	-0653032	47,25	-0654032	39,05
65-40	80,0	77,0	70,0	66,0	40,0	0,510	-0651040	31,65	-0652040	25,60	-0653040	47,45	-0654040	39,05
65-50	80,0	82,0	70,0	66,0	52,0	0,600	-0651050	31,75	-0652050	25,70	-0653050	47,60	-0654050	39,35
80-25	90,0	82,0	85,0	81,0	28,0	0,730	-0801025	39,75	-0802025	31,60	-0803025	58,90	-0804025	51,50
80-32	90,0	84,0	85,0	81,0	34,0	0,730	-0801032	40,60	-0802032	31,60	-0803032	58,90	-0804032	51,50
80-40	90,0	85,5	85,0	81,0	40,0	0,740	-0801040	41,00	-0802040	32,10	-0803040	60,40	-0804040	51,50
80-50	90,0	92,0	85,0	81,0	52,0	0,760	-0801050	41,35	-0802050	33,00	-0803050	61,10	-0804050	51,90
80-65	90,0	90,0	85,0	81,0	70,0	0,840	-0801065	42,20	-0802065	33,80	-0803065	62,50	-0804065	56,20
100-25	100,0	92,0	104,0	100,0	28,0	1,020	-1001025	52,50	-1002025	37,90	-1003025	80,25	-1004025	70,40
100-32	100,0	94,0	104,0	100,0	34,0	1,040	-1001032	52,50	-1002032	43,20	-1003032	80,25	-1004032	70,40
100-40	100,0	95,0	104,0	100,0	40,0	1,060	-1001040	52,50	-1002040	43,20	-1003040	80,25	-1004040	70,40
100-50	100,0	103,0	104,0	100,0	52,0	1,080	-1001050	52,50	-1002050	43,20	-1003050	80,25	-1004050	70,40
100-65	100,0	101,0	104,0	100,0	70,0	1,170	-1001065	52,50	-1002065	43,20	-1003065	80,25	-1004065	70,40
100-80	100,0	106,0	104,0	100,0	85,0	1,240	-1001080	55,30	-1002080	43,20	-1003080	80,25	-1004080	70,40
125-25	187,5	104,0	129,0	125,0	28,0	2,020	-1251025	170,60	-1252025	143,80	-1253025	235,50	-1254025	213,90
125-32	187,5	106,0	129,0	125,0	34,0	2,030	-1251032	173,65	-1252032	143,80	-1253032	239,95	-1254032	218,80
125-40	187,5	107,0	129,0	125,0	40,0	2,040	-1251040	175,40	-1252040	143,80	-1253040	242,65	-1254040	221,70
125-50	187,5	110,0	129,0	125,0	52,0	2,070	-1251050	177,20	-1252050	143,80	-1253050	245,30	-1254050	224,60
125-65	187,5	110,0	129,0	125,0	70,0	2,080	-1251065	178,40	-1252065	143,80	-1253065	247,10	-1254065	226,60
125-80	187,5	113,0	129,0	125,0	85,0	2,170	-1251080	181,35	-1252080	143,80	-1253080	251,60	-1254080	229,05
125-100	187,5	113,0	129,0	125,0	104,0	2,220	-1251100	183,15	-1252100	143,80	-1253100	254,20	-1254100	230,75
150-40	225,0	120,0	154,0	150,0	40,0	2,990	-1501040	232,75	-1502040	190,75	-1503040	346,15	-1504040	308,55
150-50	225,0	123,0	154,0	150,0	52,0	3,020	-1501050	234,55	-1502050	192,55	-1503050	349,45	-1504050	310,90
150-65	225,0	123,0	154,0	150,0	70,0	3,030	-1501065	236,95	-1502065	194,90	-1503065	352,90	-1504065	315,20
150-80	225,0	125,0	154,0	150,0	85,0	3,090	-1501080	238,70	-1502080	196,70	-1503080	355,35	-1504080	318,00
150-100	225,0	125,0	154,0	150,0	104,0	3,180	-1501100	240,50	-1502100	198,50	-1503100	358,95	-1504100	321,10
150-125	225,0	198,0	154,0	150,0	129,0	3,390	-1501125	242,30	-1502125	200,25	-1503125	361,75	-1504125	323,90

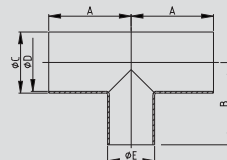
**Red-T-Stück
SSS lang**
**reduced welding tee
DIN long**

4.06 Red-T-Stück lang

4.06 reduced welding tee long

Red-T-Stück
ähnl. DIN 11852-TS

reduced welding tee
sim. DIN 11852-TS

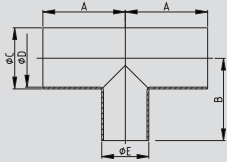

Art.-Nr. 42282-								AISI 304/304L-1.4301/1.4307				AISI 316L-1.4404			
DN	A	B	C	D	E	Gew.	Art.-Nr.	Preis	Art.-Nr.	Preis	Art.-Nr.	Preis	Art.-Nr.	Preis	
	mm	mm	mm	mm	mm	kg	poliert	EUR	matt	EUR	poliert	EUR	matt	EUR	
15-10	35,0	29,0	19,0	16,0	13,0	0,050					-0153010	42,55	-0154010	39,40	
20-10	40,0	31,0	23,0	20,0	13,0	0,080					-0203010	25,35	-0204010	40,30	
20-15	40,0	37,0	23,0	20,0	19,0	0,080	-0201015	28,05	-0202015	25,35	-0203015	40,30	-0204015	37,65	
25-10	50,0	34,0	29,0	26,0	13,0	0,090					-0253010	31,90	-0254010	30,95	
25-15	50,0	40,0	29,0	26,0	19,0	0,100	-0251015	22,00	-0252015	18,70	-0253015	30,05	-0254015	29,20	
25-20	50,0	43,0	29,0	26,0	23,0	0,100	-0251020	18,35	-0252020	15,25	-0253020	25,05	-0254020	23,80	
32-15	55,0	43,0	35,0	32,0	19,0	0,150	-0321015	25,20	-0322015	21,05	-0323015	36,40	-0324015	33,75	
32-20	55,0	46,0	35,0	32,0	23,0	0,150	-0321020	23,80	-0322020	19,70	-0323020	34,35	-0324020	31,55	
32-25	55,0	53,0	35,0	32,0	29,0	0,150	-0321025	20,50	-0322025	16,20	-0323025	29,60	-0324025	24,30	
40-20	60,0	49,0	41,0	38,0	23,0	0,160	-0401020	25,15	-0402020	19,30	-0403020	34,85	-0404020	32,15	
40-25	60,0	56,0	41,0	38,0	29,0	0,180	-0401025	22,15	-0402025	16,60	-0403025	30,70	-0404025	27,65	
40-32	60,0	58,0	41,0	38,0	35,0	0,200	-0401032	23,15	-0402032	17,35	-0403032	31,45	-0404032	28,85	
50-25	70,0	62,0	53,0	50,0	29,0	0,270	-0501025	24,80	-0502025	18,00	-0503025	35,15	-0504025	29,95	
50-32	70,0	64,0	53,0	50,0	35,0	0,270	-0501032	25,05	-0502032	18,35	-0503032	35,15	-0504032	29,95	
50-40	70,0	66,0	53,0	50,0	41,0	0,310	-0501040	26,45	-0502040	19,55	-0503040	37,45	-0504040	30,50	
65-25	80,0	70,5	70,0	66,0	29,0	0,500	-0651025	42,50	-0652025	34,30	-0653025	63,80	-0654025	48,65	
65-32	80,0	72,5	70,0	66,0	35,0	0,500	-0651032	42,50	-0652032	34,30	-0653032	63,80	-0654032	48,65	
65-40	80,0	74,5	70,0	66,0	41,0	0,510	-0651040	42,70	-0652040	34,60	-0653040	64,05	-0654040	49,10	
65-50	80,0	78,5	70,0	66,0	53,0	0,600	-0651050	42,85	-0652050	34,70	-0653050	64,25	-0654050	49,60	
80-25	90,0	80,0	85,0	81,0	29,0	0,730	-0801025	54,80	-0802025	42,65	-0803025	79,50	-0804025	69,50	
80-32	90,0	81,5	85,0	81,0	35,0	0,730	-0801032	54,80	-0802032	42,65	-0803032	79,50	-0804032	69,50	
80-40	90,0	82,0	85,0	81,0	41,0	0,740	-0801040	55,35	-0802040	43,35	-0803040	81,55	-0804040	69,50	
80-50	90,0	86,0	85,0	81,0	53,0	0,760	-0801050	55,85	-0802050	44,55	-0803050	82,50	-0804050	70,05	
100-25	100,0	92,0	104,0	100,0	29,0	1,020	-1001025	63,65	-1002025	51,15	-1003025	95,45	-1004025	83,40	
100-32	100,0	93,5	104,0	100,0	35,0	1,040	-1001032	64,30	-1002032	52,25	-1003032	96,30	-1004032	83,90	
100-40	100,0	95,0	104,0	100,0	41,0	1,060	-1001040	64,70	-1002040	52,25	-1003040	96,75	-1004040	84,60	
100-50	100,0	95,5	104,0	100,0	53,0	1,080	-1001050	65,45	-1002050	54,10	-1003050	97,75	-1004050	85,30	
125-25	187,5	108,0	129,0	125,0	29,0	2,020	-1251025	230,35	-1252025	177,20	-1253025	317,90	-1254025	288,10	
125-32	187,5	109,5	129,0	125,0	35,0	2,030	-1251032	234,40	-1252032	177,20	-1253032	323,95	-1254032	295,35	
125-40	187,5	111,0	129,0	125,0	41,0	2,040	-1251040	236,85	-1252040	183,70	-1253040	327,60	-1254040	299,30	
125-50	187,5	114,0	129,0	125,0	53,0	2,070	-1251050	239,25	-1252050	186,10	-1253050	331,20	-1254050	303,20	
150-40	225,0	127,0	154,0	150,0	41,0	2,990	-1501040	314,20	-1502040	257,55	-1503040	467,30	-1504040	416,60	
150-50	225,0	130,0	154,0	150,0	53,0	3,020	-1501050	316,60	-1502050	259,95	-1503050	471,80	-1504050	419,75	

4.07 Red-T-Stück (Zoll), Walz-T-Stück
4.07 reduced welding tee (inch), expanding tee
Art.-Nr. 42271-

							AISI 304/304L-1.4301/1.4307				AISI 316L-1.4404			
DN	A	B	C	D	E	Gew.	Art.-Nr.	Preis	Art.-Nr.	Preis	Art.-Nr.	Preis	Art.-Nr.	Preis
mm	mm	mm	mm	mm	mm	kg	poliert	EUR	matt	EUR	poliert	EUR	matt	EUR
1,5-1"	60,0	35,1	38,1	20,0	22,9	0,140	-1121100	15,70	-1122100	19,20	-1123100	25,40	-1124100	29,45
2-1"	70,0	47,8	50,8	27,5	22,9	0,220	-2001100	18,10	-2002100	22,50	-2003100	29,70	-2004100	34,00
2-1,5"	70,0	47,8	50,8	27,5	35,1	0,230	-2001112	18,45	-2002112	28,40	-2003112	29,85	-2004112	34,20
2,5-1"	80,0	60,2	63,5	36,0	22,9	0,340	-2121100	25,80	-2122100	31,90	-2123100	41,95	-2124100	47,50
2,5-1,5"	80,0	60,2	63,5	36,0	35,1	0,340	-2121112	25,90	-2122112	32,05	-2123112	42,20	-2124112	47,70
2,5-2"	80,0	60,2	63,5	36,0	47,8	0,340	-2121200	25,95	-2122200	32,15	-2123200	42,50	-2124200	48,05
3-1"	90,0	72,8	76,1	44,0	22,9	0,620	-3001100	33,50	-3002100	42,10	-3003100	54,25	-3004100	62,55
3-1,5"	90,0	72,8	76,1	44,0	35,1	0,620	-3001112	33,50	-3002112	42,10	-3003112	54,25	-3004112	62,55
3-2"	90,0	72,8	76,1	44,0	47,8	0,620	-3001200	33,80	-3002200	42,10	-3003200	54,90	-3004200	63,00
3-2,5"	90,0	72,8	76,1	44,0	60,2	0,620	-3001212	34,55	-3002212	43,15	-3003212	56,70	-3004212	65,00
4-1,5"	100,0	97,4	101,6	56,0	35,1	0,890	-4001112	41,95	-4002112	52,25	-4003112	67,85	-4004112	77,65
4-2"	100,0	97,4	101,6	56,0	47,8	0,890	-4001200	42,50	-4002200	52,55	-4003200	68,80	-4004200	78,50
4-2,5"	100,0	97,4	101,6	56,0	60,2	0,890	-4001212	44,00	-4002212	54,45	-4003212	71,20	-4004212	81,45
4-3"	100,0	97,4	101,6	56,0	72,8	0,890	-4001300	44,95	-4002300	55,40	-4003300	73,00	-4004300	83,20

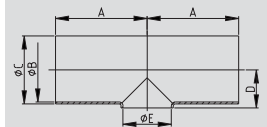
**Red-T-Stück SSS
kurz (Zoll)**
**reduced welding tee
inch short**

Art.-Nr. 42281-

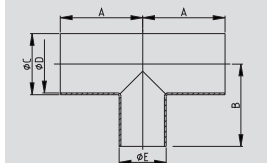
							AISI 304/304L-1.4301/1.4307				AISI 316L-1.4404			
DN	A	B	C	D	E	Gew.	Art.-Nr.	Preis	Art.-Nr.	Preis	Art.-Nr.	Preis	Art.-Nr.	Preis
mm	mm	mm	mm	mm	mm	kg	poliert	EUR	matt	EUR	poliert	EUR	matt	EUR
1,5-1"	60,0	56,0	38,1	35,1	25,4	0,150	-1121100	22,15	-1122100	17,65	-1123100	31,60	-1124100	27,65
2-1"	70,0	63,5	50,8	47,8	25,4	0,230	-2001100	25,50	-2002100	19,05	-2003100	34,95	-2004100	30,45
2-1,5"	70,0	67,5	50,8	47,8	38,1	0,240	-2001112	26,30	-2002112	20,55	-2003112	36,35	-2004112	31,45
2,5-1"	80,0	72,0	63,5	60,2	25,4	0,440	-2121100	35,30	-2122100	28,50	-2123100	51,95	-2124100	40,35
2,5-1,5"	80,0	76,0	63,5	60,2	38,1	0,450	-2121112	36,05	-2122112	28,80	-2123112	52,20	-2124112	40,75
2,5-2"	80,0	78,5	63,5	60,2	50,8	0,460	-2121200	36,35	-2122200	29,10	-2123200	52,60	-2124200	41,20
3-1"	90,0	80,0	76,1	72,8	25,4	0,890	-3001100	44,65	-3002100	34,70	-3003100	64,40	-3004100	56,25
3-1,5"	90,0	84,0	76,1	72,8	38,1	0,900	-3001112	45,10	-3002112	35,35	-3003112	65,95	-3004112	57,00
3-2"	90,0	86,5	76,1	72,8	50,8	0,910	-3001200	45,45	-3002200	36,30	-3003200	66,30	-3004200	57,80
3-2,5"	90,0	90,0	76,1	72,8	63,5	0,920	-3001212	46,40	-3002212	37,15	-3003212	66,70	-3004212	59,90
4-1,5"	100,0	93,0	101,6	97,4	38,1	0,980	-4001112	52,70	-4002112	42,65	-4003112	74,55	-4004112	65,35
4-2"	100,0	98,5	101,6	97,4	50,8	1,020	-4001200	56,85	-4002200	44,05	-4003200	75,50	-4004200	66,30
4-2,5"	100,0	100,0	101,6	97,4	63,5	1,050	-4001212	60,10	-4002212	46,10	-4003212	80,95	-4004212	72,65
4-3"	100,0	102,0	101,6	97,4	76,1	1,120	-4001300	61,25	-4002300	48,35	-4003300	84,45	-4004300	76,30

**Red-T-Stück SSS
lang (Zoll)**
**reduced weld. tee
inch long**

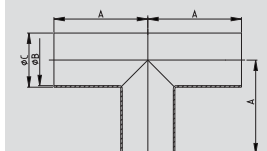
Art.-Nr. 43330-

							AISI 304/304L-1.4301/1.4307				AISI 316L-1.4404			
DN	A	B	C	D	E	Gew.	Art.-Nr.	Preis	Art.-Nr.	Preis	Art.-Nr.	Preis	Art.-Nr.	Preis
mm	mm	mm	mm	mm	mm	kg	poliert	EUR	matt	EUR	poliert	EUR	matt	EUR
10	34,0	9,0	12,0			0,020	-0101	19,45	-0102	15,60	-0103	29,45	-0104	25,05
15	43,0	15,0	18,0			0,050	-0151	21,15	-0152	17,00	-0153	31,75	-0154	27,75
20	47,0	19,0	22,0			0,070	-0201	16,45	-0202	13,35	-0203	24,80	-0204	21,85
25	58,0	25,0	28,0			0,130	-0251	15,65	-0252	12,75	-0253	23,10	-0254	20,30
32	63,0	31,0	34,0			0,180	-0321	17,55	-0322	14,30	-0323	25,85	-0324	22,65
40	69,0	37,0	40,0			0,230	-0401	19,45	-0402	15,70	-0403	29,15	-0404	25,50
50	80,0	49,0	52,0			0,350	-0501	25,65	-0502	20,30	-0503	34,25	-0504	30,10
65	90,0	66,0	70,0			0,700	-0651	33,35	-0652	26,90	-0653	49,00	-0654	42,70
80	98,0	81,0	85,0			0,910	-0801	43,50	-0802	35,20	-0803	57,95	-0804	51,10
100	111,0	100,0	104,0			1,220	-1001	59,35	-1002	48,05	-1003	74,80	-1004	63,50

T-Stück WWW
expanding tee DIN

4.08 T-Stück mit Anschlüssen
4.08 tee with sockets

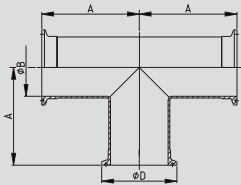
T-Stück CCC tee DIN clamp/clamp/clamp	Art.-Nr. 44440-							AISI 304/304L-1.4301/1.4307				AISI 316L-1.4404			
	DN	A	B	C	D	E	Gew.	Art.-Nr.	Preis	Art.-Nr.	Preis	Art.-Nr.	Preis	Art.-Nr.	Preis
	mm	mm	mm	mm	mm	mm	kg	poliert	EUR	matt	EUR	poliert	EUR	matt	EUR
10	39,0	10,0		34,0		0,160	-0101	74,85	-0102	74,85	-0103	85,65	-0104	85,65	
15	48,0	16,0		34,0		0,170	-0151	76,40	-0152	76,40	-0153	89,55	-0154	89,55	
20	53,0	20,0		34,0		0,180	-0201	77,15	-0202	77,15	-0203	90,10	-0204	90,10	
25	63,0	26,0		50,5		0,310	-0251	79,85	-0252	79,85	-0253	92,40	-0254	92,40	
32	68,0	32,0		50,5		0,330	-0321	86,90	-0322	86,90	-0323	100,95	-0324	100,95	
40	73,0	38,0		50,5		0,340	-0401	82,75	-0402	82,75	-0403	96,05	-0404	96,05	
50	83,0	50,0		64,0		0,500	-0501	92,40	-0502	92,40	-0503	100,00	-0504	100,00	
65	93,0	66,0		91,0		0,920	-0651	120,35	-0652	120,35	-0653	142,90	-0654	142,90	
80	103,0	81,0		106,0		1,450	-0801	150,25	-0802	150,25	-0803	174,05	-0804	174,05	
100	113,0	100,0		119,0		1,740	-1001	186,95	-1002	186,95	-1003	232,60	-1004	232,60	



T-Stück CCC (Zoll) tee inch clamp/clamp/clamp	Art.-Nr. 44441-							AISI 304/304L-1.4301/1.4307				AISI 316L-1.4404			
	DN	A	B	C	D	E	Gew.	Art.-Nr.	Preis	Art.-Nr.	Preis	Art.-Nr.	Preis	Art.-Nr.	Preis
	mm	mm	mm	mm	mm	mm	kg	poliert	EUR	matt	EUR	poliert	EUR	matt	EUR
1"	63,0	22,9		50,5		0,200	-1001	87,85	-1002	87,85	-1003	101,60	-1004	101,60	
1,5"	73,0	35,1		50,5		0,240	-1121	91,00	-1122	91,00	-1123	105,70	-1124	105,70	
2"	83,0	47,8		64,0		0,460	-2001	101,55	-2002	101,55	-2003	109,95	-2004	109,95	
2,5"	93,0	60,2		77,5		0,730	-2121	132,35	-2122	132,35	-2123	156,85	-2124	156,85	
3"	103,0	72,8		91,0		1,280	-3001	164,95	-3002	164,95	-3003	191,45	-3004	191,45	
4"	113,0	97,4		119,0		1,760	-4001	205,10	-4002	205,10	-4003	255,70	-4004	255,70	

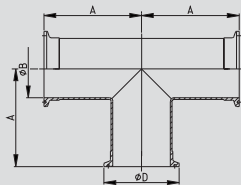

T-Stück GGG tee DIN male/male/male	Art.-Nr. 45550-							AISI 304/304L-1.4301/1.4307				AISI 316L-1.4404			
	DN	A	B	C	D	E	Gew.	Art.-Nr.	Preis	Art.-Nr.	Preis	Art.-Nr.	Preis	Art.-Nr.	Preis
	mm	mm	mm	mm	mm	mm	kg	poliert	EUR	matt	EUR	poliert	EUR	matt	EUR
10	43,0		10,0		Rd28x1/8	0,145	-0101	51,65	-0102	51,65	-0103	76,85	-0104	76,85	
15	52,0		16,0		Rd34x1/8	0,195	-0151	53,30	-0152	53,30	-0153	78,80	-0154	78,80	
20	59,0		20,0		Rd44x1/6	0,295	-0201	54,85	-0202	54,85	-0203	80,10	-0204	80,10	
25	72,0		26,0		Rd52x1/6	0,390	-0251	52,70	-0252	52,70	-0253	64,80	-0254	64,80	
32	77,0		32,0		Rd58x1/6	0,450	-0321	54,30	-0322	54,30	-0323	67,25	-0324	67,25	
40	82,0		38,0		Rd65x1/6	0,595	-0401	57,90	-0402	57,90	-0403	69,85	-0404	69,85	
50	93,0		50,0		Rd78x1/6	0,760	-0501	68,10	-0502	68,10	-0503	84,50	-0504	84,50	
65	105,0		66,0		Rd95x1/6	1,420	-0651	87,50	-0652	87,50	-0653	113,50	-0654	113,50	
80	115,0		81,0		Rd110x1/4	2,070	-0801	123,35	-0802	123,35	-0803	182,15	-0804	182,15	
100	130,0		100,0		Rd130x1/4	3,340	-1001	173,15	-1002	173,15	-1003	255,70	-1004	255,70	

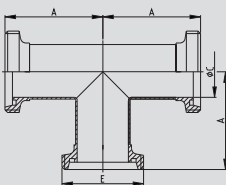

Rd: Rundgewinde

Rd: round thread

4.09 T-Stück mit Anschlüssen
4.09 tee with sockets

Art.-Nr. 45560-							AISI 304/304L-1.4301/1.4307				AISI 316L-1.4404			
DN	A	B	C	D	E	Gew.	Art.-Nr.	Preis	Art.-Nr.	Preis	Art.-Nr.	Preis	Art.-Nr.	Preis
mm	mm	mm	mm	mm	mm	kg	poliert	EUR	matt	EUR	poliert	EUR	matt	EUR
10	43,0	39,0	10,0		Rd28x1/8	0,200	-0101	53,30	-0102	53,30	-0103	77,00	-0104	77,00
15	52,0	48,0	16,0		Rd34x1/8	0,250	-0151	62,30	-0152	62,30	-0153	89,25	-0154	89,25
20	59,0	53,0	20,0		Rd44x1/6	0,390	-0201	60,00	-0202	60,00	-0203	86,25	-0204	86,25
25	72,0	65,0	26,0		Rd52x1/6	0,530	-0251	59,75	-0252	59,75	-0253	74,50	-0254	74,50
32	77,0	70,0	32,0		Rd58x1/6	0,625	-0321	64,75	-0322	64,75	-0323	81,05	-0324	81,05
40	82,0	75,0	38,0		Rd65x1/6	0,770	-0401	70,00	-0402	70,00	-0403	88,05	-0404	88,05
50	93,0	86,0	50,0		Rd78x1/6	1,030	-0501	82,95	-0502	82,95	-0503	104,45	-0504	104,45
65	105,0	97,0	66,0		Rd95x1/6	1,880	-0651	115,20	-0652	115,20	-0653	144,35	-0654	144,35
80	115,0	107,0	81,0		Rd110x1/4	2,700	-0801	161,80	-0802	161,80	-0803	229,95	-0804	229,95
100	130,0	120,0	100,0		Rd130x1/4	4,020	-1001	232,50	-1002	232,50	-1003	330,25	-1004	330,25

Rd: Rundgewinde Rd: round thread

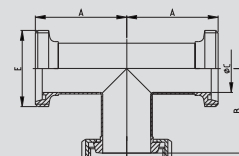
T-Stück GKG
tee DIN
male/male/liner

Art.-Nr. 45650-							AISI 304/304L-1.4301/1.4307				AISI 316L-1.4404			
DN	A	B	C	D	E	Gew.	Art.-Nr.	Preis	Art.-Nr.	Preis	Art.-Nr.	Preis	Art.-Nr.	Preis
mm	mm	mm	mm	mm	mm	kg	poliert	EUR	matt	EUR	poliert	EUR	matt	EUR
10	43,0	39,0	10,0		Rd28x1/8	0,200	-0101	53,30	-0102	53,30	-0103	77,00	-0104	77,00
15	52,0	48,0	16,0		Rd34x1/8	0,250	-0151	62,30	-0152	62,30	-0153	89,25	-0154	89,25
20	59,0	53,0	20,0		Rd44x1/6	0,390	-0201	60,00	-0202	60,00	-0203	86,25	-0204	86,25
25	72,0	65,0	26,0		Rd52x1/6	0,530	-0251	59,75	-0252	59,75	-0253	74,50	-0254	74,50
32	77,0	70,0	32,0		Rd58x1/6	0,625	-0321	64,75	-0322	64,75	-0323	81,05	-0324	81,05
40	82,0	75,0	38,0		Rd65x1/6	0,770	-0401	70,00	-0402	70,00	-0403	88,05	-0404	88,05
50	93,0	86,0	50,0		Rd78x1/6	1,030	-0501	82,95	-0502	82,95	-0503	104,45	-0504	104,45
65	105,0	97,0	66,0		Rd95x1/6	1,880	-0651	115,20	-0652	115,20	-0653	144,35	-0654	144,35
80	115,0	107,0	81,0		Rd110x1/4	2,700	-0801	161,80	-0802	161,80	-0803	229,95	-0804	229,95
100	130,0	120,0	100,0		Rd130x1/4	4,020	-1001	232,50	-1002	232,50	-1003	330,25	-1004	330,25

Rd: Rundgewinde Rd: round thread

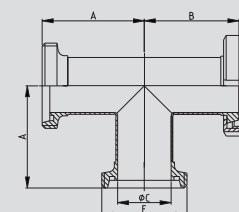
T-Stück GKG
tee DIN
male/liner/male

Art.-Nr. 45660-							AISI 304/304L-1.4301/1.4307				AISI 316L-1.4404			
DN	A	B	C	D	E	Gew.	Art.-Nr.	Preis	Art.-Nr.	Preis	Art.-Nr.	Preis	Art.-Nr.	Preis
mm	mm	mm	mm	mm	mm	kg	poliert	EUR	matt	EUR	poliert	EUR	matt	EUR
10	43,0	39,0	10,0		Rd28x1/8	0,250	-0101	60,80	-0102	60,80	-0103	85,40	-0104	85,40
15	52,0	48,0	16,0		Rd34x1/8	0,300	-0151	72,95	-0152	72,95	-0153	101,00	-0154	101,00
20	59,0	53,0	20,0		Rd44x1/6	0,450	-0201	68,15	-0202	68,15	-0203	94,65	-0204	94,65
25	72,0	65,0	26,0		Rd52x1/6	0,650	-0251	72,30	-0252	72,30	-0253	87,90	-0254	87,90
32	77,0	70,0	32,0		Rd58x1/6	0,800	-0321	79,95	-0322	79,95	-0323	97,05	-0324	97,05
40	82,0	75,0	38,0		Rd65x1/6	0,950	-0401	84,35	-0402	84,35	-0403	103,90	-0404	103,90
50	93,0	86,0	50,0		Rd78x1/6	1,300	-0501	100,45	-0502	100,45	-0503	123,80	-0504	123,80
65	105,0	97,0	66,0		Rd95x1/6	2,300	-0651	141,80	-0652	141,80	-0653	173,50	-0654	173,50
80	115,0	107,0	81,0		Rd110x1/4	3,400	-0801	200,40	-0802	200,40	-0803	275,55	-0804	275,55
100	130,0	120,0	100,0		Rd130x1/4	5,100	-1001	293,35	-1002	293,35	-1003	404,70	-1004	404,70

Rd: Rundgewinde Rd: round thread

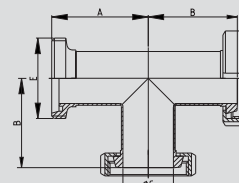
T-Stück GKG
tee DIN
male/liner/liner

4.10 T-Stück mit Anschlüssen

4.10 tee with sockets

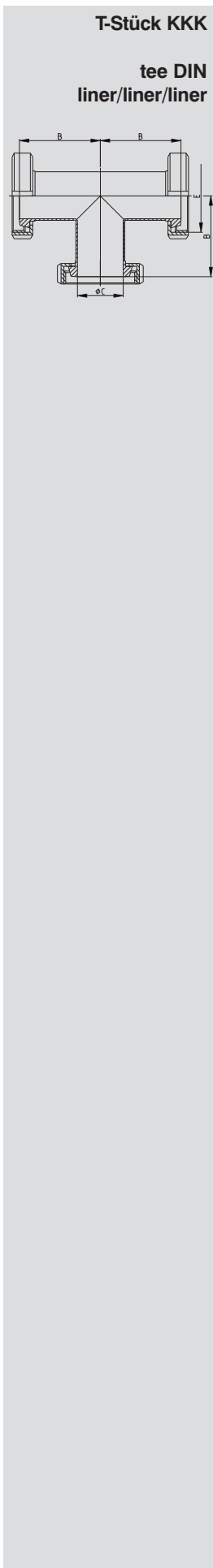

Art.-Nr. 46660-							AISI 304/304L-1.4301/1.4307				AISI 316L-1.4404			
DN	A	B	C	D	E	Gew.	Art.-Nr.	Preis	Art.-Nr.	Preis	Art.-Nr.	Preis	Art.-Nr.	Preis
mm	mm	mm	mm	mm	mm	kg	poliert	EUR	matt	EUR	poliert	EUR	matt	EUR
10		39,0	10,0		Rd28x1/8	0,300	-0101	67,65	-0102	67,65	-0103	92,75	-0104	92,75
15		48,0	16,0		Rd34x1/8	0,350	-0151	83,25	-0152	83,25	-0153	112,35	-0154	112,35
20		53,0	20,0		Rd44x1/6	0,520	-0201	76,15	-0202	76,15	-0203	102,85	-0204	102,85
25		65,0	26,0		Rd52x1/6	0,830	-0251	84,85	-0252	84,85	-0253	101,00	-0254	101,00
32		70,0	32,0		Rd58x1/6	0,970	-0321	93,65	-0322	93,65	-0323	112,75	-0324	112,75
40		75,0	38,0		Rd65x1/6	1,150	-0401	98,95	-0402	98,95	-0403	120,00	-0404	120,00
50		86,0	50,0		Rd78x1/6	1,569	-0501	118,20	-0502	118,20	-0503	143,50	-0504	143,50
65		97,0	66,0		Rd95x1/6	2,810	-0651	168,90	-0652	168,90	-0653	203,45	-0654	203,45
80		107,0	81,0		Rd110x1/4	3,810	-0801	240,90	-0802	240,90	-0803	323,70	-0804	323,70
100		120,0	100,0		Rd130x1/4	6,010	-1001	356,10	-1002	356,10	-1003	481,30	-1004	481,30

Rd: Rundgewinde

Rd: round thread

4.11 T-Bogen
4.11 welding tee bend

Art.-Nr. 47200-							AISI 304/304L-1.4301/1.4307				AISI 316L-1.4404			
DN	A	B	C	D	E	Gew.	Art.-Nr.	Preis	Art.-Nr.	Preis	Art.-Nr.	Preis	Art.-Nr.	Preis
mm	mm	mm	mm	mm	mm	kg	poliert	EUR	matt	EUR	poliert	EUR	matt	EUR
15	34,0	35,0	15,0			0,080	-0151	52,05	-0152	52,05	-0153	67,40	-0154	67,40
20	39,0	40,0	19,0			0,090	-0201	50,40	-0202	50,40	-0203	66,15	-0204	66,15
25	49,0	50,0	25,0			0,110	-0251	48,05	-0252	48,05	-0253	64,65	-0254	64,65
32	54,0	55,0	31,0			0,150	-0321	50,15	-0322	50,15	-0323	68,80	-0324	68,80
40	59,0	60,0	37,0			0,190	-0401	51,75	-0402	51,75	-0403	71,05	-0404	71,05
50	69,0	70,0	49,0			0,300	-0501	58,60	-0502	58,60	-0503	75,75	-0504	75,75
65	79,0	80,0	66,0			0,590	-0651	76,80	-0652	76,80	-0653	95,95	-0654	95,95
80	89,0	90,0	81,0			0,810	-0801	103,30	-0802	103,30	-0803	128,25	-0804	128,25
100	99,0	100,0	100,0			1,620	-1001	130,05	-1002	130,05	-1003	160,80	-1004	160,80
125	186,5	187,5	125,0			2,710	-1251	245,95	-1252	245,95	-1253	327,60	-1254	327,60
150	224,0	225,0	150,0			3,880	-1501	322,80	-1502	322,80	-1503	408,45	-1504	408,45

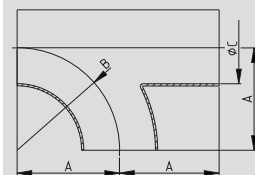
T-Bogen SSS
**welding tee bend
DIN**

Art.-Nr. 47201-							AISI 304/304L-1.4301/1.4307				AISI 316L-1.4404			
DN	A	B	C	D	E	Gew.	Art.-Nr.	Preis	Art.-Nr.	Preis	Art.-Nr.	Preis	Art.-Nr.	Preis
mm	mm	mm	mm	mm	mm	kg	poliert	EUR	matt	EUR	poliert	EUR	matt	EUR
1"	26,5	27,5	22,9			0,100	-1001	57,60	-1002	57,60	-1003	77,55	-1004	77,55
1,5"	44,0	45,0	35,1			0,180	-1121	62,05	-1122	62,05	-1123	85,20	-1124	85,20
2"	66,5	67,5	47,8			0,280	-2001	70,30	-2002	70,30	-2003	90,90	-2004	90,90
2,5"	81,5	82,5	60,2			0,530	-2121	92,20	-2122	92,20	-2123	114,85	-2124	114,85
3"	94,0	95,0	72,8			0,720	-3001	124,00	-3002	124,00	-3003	153,85	-3004	153,85
4"	132,5	133,5	97,4			1,510	-4001	156,05	-4002	156,05	-4003	192,95	-4004	192,95

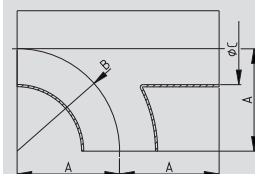
T-Bogen SSS (Zoll)
**welding tee bend
inch**

Art.-Nr. 47220-							AISI 304/304L-1.4301/1.4307				AISI 316L-1.4404			
DN	A	B	C	D	E	Gew.	Art.-Nr.	Preis	Art.-Nr.	Preis	Art.-Nr.	Preis	Art.-Nr.	Preis
mm	mm	mm	mm	mm	mm	kg	poliert	EUR	matt	EUR	poliert	EUR	matt	EUR
15	34,0	35,0	16,0			0,080					-0153	(+)	-0154	(+)
20	39,0	40,0	20,0			0,090					-0203	(+)	-0204	(+)
25	49,0	50,0	26,0			0,110	-0251	55,25	-0252	55,25	-0253	74,35	-0254	74,35
32	54,0	55,0	32,0			0,150	-0321	57,65	-0322	57,65	-0323	79,15	-0324	79,15
40	59,0	60,0	38,0			0,190	-0401	59,55	-0402	59,55	-0403	81,65	-0404	81,65
50	69,0	70,0	50,0			0,300	-0501	67,35	-0502	67,35	-0503	87,10	-0504	87,10

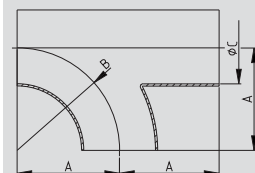
T-Bogen SSS Reihe 2
**welding tee bend
series 2**

DN65-150 siehe Art.-Nr. 47200

(+) Preis auf Anfrage

DN65-150 see item-no. 47200

(+) price on inquiry

4.12 Doppel-T-Bogen
4.12 welding Y-piece

Doppel-T-Bogen SSS welding Y-piece DIN	Art.-Nr. 47400-							AISI 304/304L-1.4301/1.4307				AISI 316L-1.4404			
	DN	A	B	C	D	E	Gew.	Art.-Nr.	Preis	Art.-Nr.	Preis	Art.-Nr.	Preis	Art.-Nr.	Preis
	mm	mm	mm	mm	mm	mm	kg	poliert	EUR	matt	EUR	poliert	EUR	matt	EUR
15	34,0	35,0	15,0				0,080	-0151	48,70	-0152	48,70	-0153	57,40	-0154	57,40
20	39,0	40,0	19,0				0,090	-0201	46,50	-0202	46,50	-0203	54,65	-0204	54,65
25	49,0	50,0	25,0				0,110	-0251	44,30	-0252	44,30	-0253	52,15	-0254	52,15
32	54,0	55,0	31,0				0,150	-0321	50,25	-0322	50,25	-0323	58,95	-0324	58,95
40	59,0	60,0	37,0				0,190	-0401	50,75	-0402	50,75	-0403	62,30	-0404	62,30
50	69,0	70,0	49,0				0,300	-0501	60,95	-0502	60,95	-0503	69,75	-0504	69,75
65	79,0	80,0	66,0				0,590	-0651	78,00	-0652	78,00	-0653	90,20	-0654	90,20
80	89,0	90,0	81,0				0,810	-0801	109,65	-0802	109,65	-0803	136,10	-0804	136,10
100	99,0	100,0	100,0				1,620	-1001	148,30	-1002	148,30	-1003	172,30	-1004	172,30
125	186,5	187,5	125,0				2,710	-1251	264,25	-1252	264,25	-1253	326,45	-1254	326,45
150	224,0	225,0	150,0				3,880	-1501	349,45	-1502	349,45	-1503	400,20	-1504	400,20

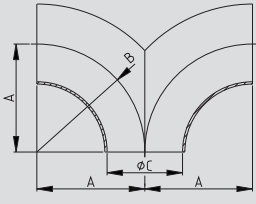

Doppel-T-Bogen SSS (Zoll) welding Y-piece inch	Art.-Nr. 47401-							AISI 304/304L-1.4301/1.4307				AISI 316L-1.4404			
	DN	A	B	C	D	E	Gew.	Art.-Nr.	Preis	Art.-Nr.	Preis	Art.-Nr.	Preis	Art.-Nr.	Preis
	mm	mm	mm	mm	mm	mm	kg	poliert	EUR	matt	EUR	poliert	EUR	matt	EUR
1"	26,5	27,5	22,9				0,100	-1001	53,25	-1002	53,25	-1003	62,60	-1004	62,60
1,5"	44,0	45,0	35,1				0,180	-1121	60,90	-1122	60,90	-1123	74,75	-1124	74,75
2"	66,5	67,5	47,8				0,280	-2001	73,15	-2002	73,15	-2003	83,70	-2004	83,70
2,5"	81,5	82,5	60,2				0,530	-2121	93,50	-2122	93,50	-2123	108,20	-2124	108,20
3"	94,0	95,0	72,8				0,720	-3001	131,60	-3002	131,60	-3003	163,25	-3004	163,25
4"	132,5	133,5	97,4				1,510	-4001	178,10	-4002	178,10	-4003	206,30	-4004	206,30

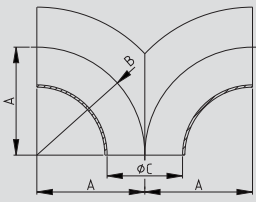

Doppel-T-Bogen SSS Reihe 2 welding Y-piece DIN series 2	Art.-Nr. 47420-							AISI 304/304L-1.4301/1.4307				AISI 316L-1.4404			
	DN	A	B	C	D	E	Gew.	Art.-Nr.	Preis	Art.-Nr.	Preis	Art.-Nr.	Preis	Art.-Nr.	Preis
	mm	mm	mm	mm	mm	mm	kg	poliert	EUR	matt	EUR	poliert	EUR	matt	EUR
15	34,0	35,0	16,0				0,080					-0153	(+)	-0154	(+)
20	39,0	40,0	20,0				0,090					-0203	(+)	-0204	(+)
25	49,0	50,0	26,0				0,110	-0251	50,90	-0252	50,90	-0253	59,95	-0254	59,95
32	54,0	55,0	32,0				0,150	-0321	57,75	-0322	57,75	-0323	67,85	-0324	67,85
40	59,0	60,0	38,0				0,190	-0401	58,40	-0402	58,40	-0403	71,65	-0404	71,65
50	69,0	70,0	50,0				0,300	-0501	70,10	-0502	70,10	-0503	80,25	-0504	80,25

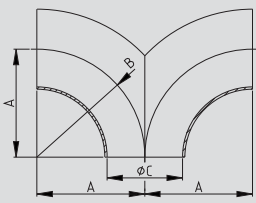
 DN65-150 siehe Art.-Nr. 47400
 (+) Preis auf Anfrage

 DN65-150 see item-no. 47400
 (+) price on inquiry

4.13 Kreuzstück kurz
4.13 welding cross short

Art.-Nr. 47600-							AISI 304/304L-1.4301/1.4307				AISI 316L-1.4404			
DN	A	B	C	D	E	Gew.	Art.-Nr.	Preis	Art.-Nr.	Preis	Art.-Nr.	Preis	Art.-Nr.	Preis
mm	mm	mm	mm	mm	mm	kg	poliert	EUR	matt	EUR	poliert	EUR	matt	EUR
15	35,0	15,0	18,0	10,0		0,060	-0151	20,60	-0152	20,60	-0153	28,90	-0154	28,90
20	40,0	19,0	22,0	12,0		0,070	-0201	19,45	-0202	19,45	-0203	26,05	-0204	26,05
25	50,0	25,0	28,0	15,5		0,090	-0251	18,55	-0252	18,55	-0253	24,85	-0254	24,85
32	55,0	31,0	34,0	18,5		0,130	-0321	20,25	-0322	20,25	-0323	26,15	-0324	26,15
40	60,0	37,0	40,0	21,5		0,150	-0401	21,80	-0402	21,80	-0403	28,00	-0404	28,00
50	70,0	49,0	52,0	28,0		0,240	-0501	23,75	-0502	23,75	-0503	29,30	-0504	29,30
65	80,0	66,0	70,0	40,0		0,490	-0651	31,05	-0652	31,05	-0653	42,90	-0654	42,90
80	90,0	81,0	85,0	45,5		0,640	-0801	42,05	-0802	42,05	-0803	52,20	-0804	52,20
100	100,0	100,0	104,0	58,0		0,910	-1001	53,60	-1002	53,60	-1003	66,95	-1004	66,95
125	187,5	125,0	129,0	71,5		1,970	-1251	142,40	-1252	142,40	-1253	171,10	-1254	171,10
150	225,0	150,0	154,0	87,0		2,890	-1501	169,55	-1502	169,55	-1503	211,65	-1504	211,65

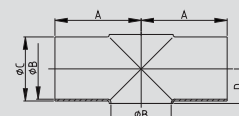
Kreuzstück SSSS kurz
welding cross DIN short

Art.-Nr. 47601-							AISI 304/304L-1.4301/1.4307				AISI 316L-1.4404			
DN	A	B	C	D	E	Gew.	Art.-Nr.	Preis	Art.-Nr.	Preis	Art.-Nr.	Preis	Art.-Nr.	Preis
mm	mm	mm	mm	mm	mm	kg	poliert	EUR	matt	EUR	poliert	EUR	matt	EUR
1"	50,0	22,9	25,4	14,0		0,060	-1001	22,25	-1002	22,25	-1003	29,75	-1004	29,75
1,5"	60,0	35,1	38,1	20,0		0,140	-1121	26,15	-1122	26,15	-1123	33,60	-1124	33,60
2"	70,0	47,8	50,8	27,5		0,230	-2001	28,55	-2002	28,55	-2003	35,15	-2004	35,15
2,5"	80,0	60,2	63,5	36,0		0,340	-2121	37,25	-2122	37,25	-2123	51,45	-2124	51,45
3"	90,0	72,8	76,1	44,0		0,620	-3001	50,45	-3002	50,45	-3003	62,65	-3004	62,65
4"	100,0	97,4	101,6	56,0		0,890	-4001	64,30	-4002	64,30	-4003	80,35	-4004	80,35

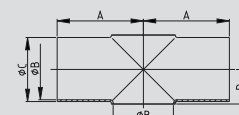
Kreuzstück SSSS kurz (Zoll)
welding cross inch short

Art.-Nr. 47620-							AISI 304/304L-1.4301/1.4307				AISI 316L-1.4404			
DN	A	B	C	D	E	Gew.	Art.-Nr.	Preis	Art.-Nr.	Preis	Art.-Nr.	Preis	Art.-Nr.	Preis
mm	mm	mm	mm	mm	mm	kg	poliert	EUR	matt	EUR	poliert	EUR	matt	EUR
15	35,0	16,0	19,0	11,0		0,060	-0151	23,70	-0152	23,70	-0153	33,25	-0154	33,25
20	40,0	20,0	23,0	13,0		0,070	-0201	22,35	-0202	22,35	-0203	30,00	-0204	30,00
25	50,0	26,0	29,0	16,5		0,090	-0251	21,35	-0252	21,35	-0253	28,55	-0254	28,55
32	55,0	32,0	35,0	19,0		0,130	-0321	23,30	-0322	23,30	-0323	30,10	-0324	30,10
40	60,0	38,0	41,0	22,5		0,150	-0401	25,10	-0402	25,10	-0403	32,20	-0404	32,20
50	70,0	50,0	53,0	29,5		0,240	-0501	27,30	-0502	27,30	-0503	33,70	-0504	33,70

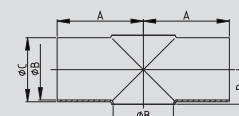
Kreuzstück SSSS kurz Reihe 2
welding cross series 2 short

DN65-150 siehe Art.-Nr. 47600

DN65-150 see item-no. 47600

4.14 Kreuzstück lang
4.14 welding cross long

Kreuzstück SSSS lang welding cross DIN long	Art.-Nr. 47800-							AISI 304/304L-1.4301/1.4307				AISI 316L-1.4404			
	DN	A	B	C	D	E	Gew.	Art.-Nr.	Preis	Art.-Nr.	Preis	Art.-Nr.	Preis	Art.-Nr.	Preis
	mm	mm	mm	mm	mm	mm	kg	poliert	EUR	matt	EUR	poliert	EUR	matt	EUR
	15	70,0	15,0				0,065	-0151	34,70	-0152	34,70	-0153	53,25	-0154	53,25
	20	80,0	19,0				0,100	-0201	33,00	-0202	33,00	-0203	50,00	-0204	50,00
	25	100,0	25,0				0,110	-0251	31,25	-0252	31,25	-0253	48,05	-0254	48,05
	32	110,0	31,0				0,150	-0321	36,60	-0322	36,60	-0323	49,85	-0324	49,85
	40	120,0	37,0				0,170	-0401	37,45	-0402	37,45	-0403	53,10	-0404	53,10
	50	140,0	49,0				0,255	-0501	39,45	-0502	39,45	-0503	62,35	-0504	62,35
	65	160,0	66,0				0,725	-0651	49,80	-0652	49,80	-0653	91,20	-0654	91,20
	80	180,0	81,0				1,130	-0801	61,60	-0802	61,60	-0803	106,70	-0804	106,70
	100	200,0	100,0				2,150	-1001	81,05	-1002	81,05	-1003	134,10	-1004	134,10
	125	375,0	125,0				3,450	-1251	213,75	-1252	213,75	-1253	273,95	-1254	273,95
	150	450,0	150,0				4,870	-1501	312,80	-1502	312,80	-1503	366,20	-1504	366,20

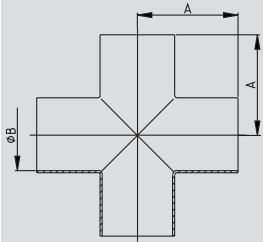

Kreuzstück SSSS lang (Zoll) welding cross inch long	Art.-Nr. 47801-							AISI 304/304L-1.4301/1.4307				AISI 316L-1.4404			
	DN	A	B	C	D	E	Gew.	Art.-Nr.	Preis	Art.-Nr.	Preis	Art.-Nr.	Preis	Art.-Nr.	Preis
	mm	mm	mm	mm	mm	mm	kg	poliert	EUR	matt	EUR	poliert	EUR	matt	EUR
	1"	100,0	22,9				0,100	-1001	37,50	-1002	37,50	-1003	57,70	-1004	57,70
	1,5"	120,0	35,1				0,180	-1121	44,90	-1122	44,90	-1123	63,75	-1124	63,75
	2"	140,0	47,8				0,350	-2001	47,30	-2002	47,30	-2003	74,80	-2004	74,80
	2,5"	160,0	60,2				0,450	-2121	59,75	-2122	59,75	-2123	109,40	-2124	109,40
	3"	180,0	72,8				0,570	-3001	73,90	-3002	73,90	-3003	128,05	-3004	128,05
	4"	200,0	97,4				1,100	-4001	97,25	-4002	97,25	-4003	160,90	-4004	160,90

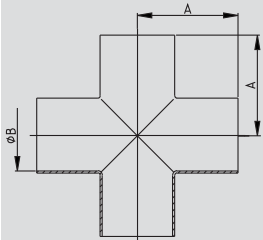

Kreuzstück SSSS lang Reihe 2 welding cross series 2 long	Art.-Nr. 47820-							AISI 304/304L-1.4301/1.4307				AISI 316L-1.4404			
	DN	A	B	C	D	E	Gew.	Art.-Nr.	Preis	Art.-Nr.	Preis	Art.-Nr.	Preis	Art.-Nr.	Preis
	mm	mm	mm	mm	mm	mm	kg	poliert	EUR	matt	EUR	poliert	EUR	matt	EUR
	15	70,0	16,0				0,065	-0151	39,90	-0152	39,90	-0153	61,25	-0154	61,25
	20	80,0	20,0				0,100	-0201	37,95	-0202	37,95	-0203	57,50	-0204	57,50
	25	100,0	26,0				0,110	-0251	35,95	-0252	35,95	-0253	55,25	-0254	55,25
	32	110,0	32,0				0,150	-0321	42,05	-0322	42,05	-0323	57,30	-0324	57,30
	40	120,0	38,0				0,170	-0401	43,10	-0402	43,10	-0403	61,05	-0404	61,05
	50	140,0	50,0				0,255	-0501	45,35	-0502	45,35	-0503	71,70	-0504	71,70

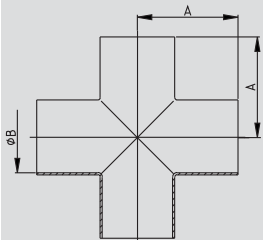

DN65-150 siehe Art.-Nr. 47800

DN65-150 see item-no. 47800



Armaturen GmbH

fon + 49 (0) 44 65 8 07 0
fax + 49 (0) 44 65 8 07 40



Armaturen GmbH

Armaturen, Rohre, Sonderteile aus Edelstahl
fittings, pipes, special parts of stainless steel

Industriestraße 24 - 26 · D-26446 Friedeburg
fon + 49 (0) 44 65 8 07 0 · fax + 49 (0) 44 65 8 07 40
mail: info@ms-armaturen.de · <http://www.ms-armaturen.de>