



Armaturen GmbH

Armaturen, Rohre, Sonderteile aus Edelstahl
fittings, pipes, special parts of stainless steel

Bogen
bends



Armaturen GmbH

fon + 49 (0) 44 65 8 07 0
fax + 49 (0) 44 65 8 07 40



Armaturen GmbH

fon: + 49 (0) 44 65 8 07 0
fax: + 49 (0) 44 65 8 07 40

3 Bogen
3 bends

Ergänzend zu unserem Katalogprogramm liefern wir auch

- Schwenkbogen
- Molchbogen
- sowie Bogen mit abweichenden Radien

Beachten Sie auch die orbitalschweißfähigen Bogen höchster Oberflächengüte aus unserem PharmCom- und HyCom-Programm in Produktgruppe 10!



Bogen
Bends

Additionally to our catalogue programme we deliver as well

- swivel bends
- bends for pigging pipelines
- and bends with differing radius

Please take a look at our bends of highest surface finish which are orbital weldable and belong to our PharmCom- and HyCom-programme in product group 10!

3.01 Schweißbogen
3.01 welding bend
Art.-Nr. 32200-

DN	A	B	C	D	E	Gew.	AISI 304L-1.4307				AISI 316L-1.4404			
							Art.-Nr.	Preis	Art.-Nr.	Preis	Art.-Nr.	Preis	Art.-Nr.	Preis
mm	mm	mm	mm	mm	mm	kg	poliert	EUR	matt/wb	EUR	poliert	EUR	matt/wb	EUR
10	26,0	9,0	12,0	26,0		0,010	-0101	5,05	-0102	4,10	-0103	5,85	-0104	4,60
15	35,0	15,0	18,0	35,0		0,030	-0151	5,65	-0152	4,30	-0153	5,90	-0154	4,50
20	40,0	19,0	22,0	40,0		0,040	-0201	5,10	-0202	4,50	-0203	6,05	-0204	5,10
25	50,0	25,0	28,0	50,0		0,070	-0251	7,10	-0252	4,60	-0253	8,60	-0254	5,80
32	55,0	31,0	34,0	55,0		0,100	-0321	8,10	-0322	5,35	-0323	9,65	-0324	7,15
40	60,0	37,0	40,0	60,0		0,130	-0401	8,70	-0402	5,70	-0403	11,00	-0404	7,75
50	70,0	49,0	52,0	70,0		0,200	-0501	10,45	-0502	7,20	-0503	13,05	-0504	9,15
65	80,0	66,0	70,0	80,0		0,350	-0651	17,65	-0652	10,75	-0653	22,00	-0654	15,85
80	90,0	81,0	85,0	90,0		0,540	-0801	28,85	-0802	17,95	-0803	35,55	-0804	25,05
100	100,0	100,0	104,0	100,0		0,730	-1001	38,10	-1002	25,05	-1003	49,10	-1004	31,70
125	187,5	125,0	129,0	187,5		1,780	-1251	94,65	-1251001	56,00	-1253	125,30	-1253001	74,15
150	225,0	150,0	154,0	225,0		2,680	-1501	116,30	-1501001	67,50	-1503	155,95	-1503001	99,70
200	300,0	200,0	204,0	300,0		4,720	-2001	189,25	-2001001	114,95	-2003	194,30	-2003001	135,50

DN65-200 gem. DIN 11852-BS 90°

DN65-200 acc. DIN 11852-BS 90°

DN125-200 matt gestrahlt auf Anfrage - wb: walzblank

DN125-200 mat blasted on inquiry - wb: bright-rolled

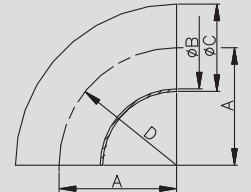
**Schweißbogen
DIN 90°**
**welding bend
DIN 90°**
Art.-Nr. 32202-

DN	A	B	C	D	E	Gew.	AISI 304L-1.4307				AISI 316L-1.4404			
							Art.-Nr.	Preis	Art.-Nr.	Preis	Art.-Nr.	Preis	Art.-Nr.	Preis
mm	mm	mm	mm	mm	mm	kg	poliert	EUR	matt	EUR	poliert	EUR	matt	EUR
10	17,0	9,0	12,0	26,0		0,008	-0101	4,05	-0102	3,10	-0103	4,70	-0104	3,45
15	24,0	15,0	18,0	35,0		0,018	-0151	4,60	-0152	3,25	-0153	4,80	-0154	3,40
20	27,0	19,0	22,0	40,0		0,025	-0201	4,00	-0202	3,40	-0203	4,80	-0204	3,85
25	34,0	25,0	28,0	50,0		0,037	-0251	5,95	-0252	3,45	-0253	7,15	-0254	4,35
32	37,0	31,0	34,0	55,0		0,050	-0321	6,80	-0322	4,05	-0323	7,90	-0324	5,40
40	41,0	37,0	40,0	60,0		0,070	-0401	6,75	-0402	3,75	-0403	8,30	-0404	5,05
50	48,0	49,0	52,0	70,0		0,100	-0501	7,95	-0502	4,70	-0503	9,85	-0504	5,95
65	55,0	66,0	70,0	80,0		0,200	-0651	13,90	-0652	7,00	-0653	16,50	-0654	10,35
80	62,0	81,0	85,0	90,0		0,285	-0801	21,70	-0802	10,80	-0803	25,55	-0804	15,05
100	69,0	100,0	104,0	100,0		0,380	-1001	28,10	-1002	15,05	-1003	36,45	-1004	19,05
125	131,0	125,0	129,0	187,5		0,890	-1251	72,25	-1252	33,60	-1253	95,65	-1254	44,50
150	157,0	150,0	154,0	225,0		1,340	-1501	89,30	-1502	40,50	-1503	116,10	-1504	59,85
200	209,0	200,0	204,0	300,0		2,360	-2001	154,80	-2002	80,50	-2003	153,65	-2004	94,85

DN65-200 gem. DIN 11852-BS 45°

DN65-200 acc. DIN 11852-BS 45°

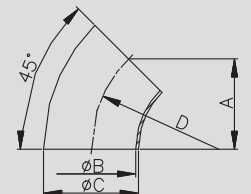
**Schweißbogen
DIN 45°**
**welding bend
DIN 45°**
Art.-Nr. 32220-

DN	A	B	C	D	E	Gew.	AISI 304L-1.4307				AISI 316L-1.4404			
							Art.-Nr.	Preis	Art.-Nr.	Preis	Art.-Nr.	Preis	Art.-Nr.	Preis
mm	mm	mm	mm	mm	mm	kg	poliert	EUR	matt	EUR	poliert	EUR	matt	EUR
10	26,0	10,0	13,0	26,0		0,010					-0103	7,10	-0104	5,70
15	35,0	16,0	19,0	35,0		0,030					-0153	7,15	-0154	5,80
20	40,0	20,0	23,0	40,0		0,040					-0203	7,95	-0204	6,45
25	50,0	26,0	29,0	50,0		0,050	-0251	7,35	-0252	4,90	-0253	9,35	-0254	6,60
32	55,0	32,0	35,0	55,0		0,080	-0321	8,55	-0322	5,75	-0323	10,25	-0324	8,15
40	60,0	38,0	41,0	60,0		0,100	-0401	9,05	-0402	6,15	-0403	11,80	-0404	8,55
50	70,0	50,0	53,0	70,0		0,170	-0501	11,00	-0502	7,95	-0503	14,20	-0504	9,95

DN65-200 siehe Art.-Nr. 32200

DN65-200 see item-no. 32200

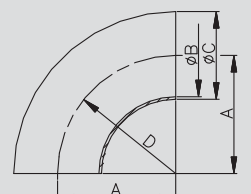

**Schweißbogen
DIN 11852-BS 90°**
**welding bend
DIN 11852-BS 90°**

3.02 Schweißbogen

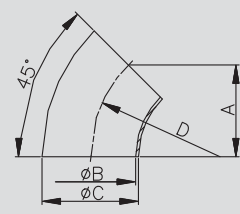
3.02 welding bend

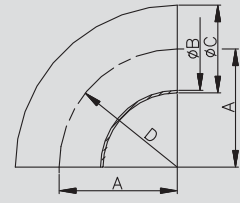
Schweißbogen DIN 11852-BS 45° welding bend DIN 11852-BS 45°	Art.-Nr. 32222-							AISI 304L-1.4307				AISI 316L-1.4404			
	DN	A	B	C	D	E	Gew.	Art.-Nr.	Preis	Art.-Nr.	Preis	Art.-Nr.	Preis	Art.-Nr.	Preis
		mm	mm	mm	mm	mm	kg	poliert	EUR	matt	EUR	poliert	EUR	matt	EUR
	10	17,0	10,0	13,0	26,0		0,005					-0103	5,70	-0104	4,30
	15	23,0	16,0	19,0	35,0		0,015					-0153	5,70	-0154	4,35
	20	27,0	20,0	23,0	40,0		0,020					-0203	6,35	-0204	4,85
	25	34,0	26,0	29,0	50,0		0,025	-0251	6,15	-0252	3,70	-0253	7,70	-0254	4,95
	32	37,0	32,0	35,0	55,0		0,040	-0321	7,15	-0322	4,35	-0323	8,25	-0324	6,15
	40	41,0	38,0	41,0	60,0		0,050	-0401	6,90	-0402	4,00	-0403	8,85	-0404	5,60
	50	48,0	50,0	53,0	70,0		0,085	-0501	8,25	-0502	5,20	-0503	10,75	-0504	6,50
	DN65-200 siehe Art.-Nr. 32202							DN65-200 see item-no. 32202							

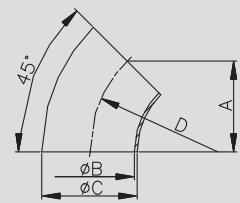
Schweißbogen Zoll 90° welding bend inch 90°	Art.-Nr. 32601-							AISI 304L-1.4307				AISI 316L-1.4404			
	DN	A	B	C	D	E	Gew.	Art.-Nr.	Preis	Art.-Nr.	Preis	Art.-Nr.	Preis	Art.-Nr.	Preis
		mm	mm	mm	mm	mm	kg	poliert	EUR	matt	EUR	poliert	EUR	matt	EUR
	1"	27,5	22,9	25,4	27,5		0,085	-1001	9,95	-1002	6,75	-1003	14,15	-1004	11,05
	1,5"	45,0	35,1	38,1	45,0		0,240	-1121	14,80	-1122	10,10	-1123	23,40	-1124	17,65
	2"	67,5	47,8	50,8	67,5		0,380	-2001	18,00	-2002	11,50	-2003	27,40	-2004	21,25
	2,5"	82,5	60,2	63,5	82,5		0,570	-2121	25,95	-2122	17,25	-2123	40,85	-2124	30,15
	3"	95,0	72,8	76,1	95,0		1,075	-3001	40,50	-3002	26,40	-3003	58,55	-3004	38,95
	4"	133,5	97,4	101,6	133,5		1,240	-4001	81,10	-4002	51,55	-4003	106,35	-4004	72,25
															

Schweißbogen Zoll 45° welding bend inch 45°	Art.-Nr. 32621-							AISI 304L-1.4307				AISI 316L-1.4404			
	DN	A	B	C	D	E	Gew.	Art.-Nr.	Preis	Art.-Nr.	Preis	Art.-Nr.	Preis	Art.-Nr.	Preis
		mm	mm	mm	mm	mm	kg	poliert	EUR	matt	EUR	poliert	EUR	matt	EUR
	1"	18,0	22,9	25,4	27,5		0,040	-1001	8,30	-1002	5,10	-1003	11,40	-1004	8,30
	1,5"	30,0	35,1	38,1	45,0		0,120	-1121	11,30	-1122	6,60	-1123	17,25	-1124	11,50
	2"	46,0	47,8	50,8	67,5		0,190	-2001	14,00	-2002	7,50	-2003	20,00	-2004	13,85
	2,5"	57,0	60,2	63,5	82,5		0,290	-2121	19,95	-2122	11,25	-2123	30,30	-2124	19,60
	3"	65,5	72,8	76,1	95,0		0,540	-3001	29,95	-3002	15,85	-3003	43,00	-3004	23,40
	4"	93,5	97,4	101,6	133,5		0,620	-4001	60,50	-4002	30,95	-4003	77,45	-4004	43,35
															

3.03 Walz- und Schweißbögen
3.03 expanding and welding bend
Art.-Nr. 33300-

							AISI 304L-1.4307				AISI 316L-1.4404			
DN	A	B	C	D	E	Gew.	Art.-Nr.	Preis	Art.-Nr.	Preis	Art.-Nr.	Preis	Art.-Nr.	Preis
							poliert	EUR	wb	EUR	poliert	EUR	wb	EUR
10	38,0	12,0	9,0	12,0		0,025	-0101	6,85	-0101001	5,70	-0103	10,30	-0103001	8,40
15	47,0	12,0	15,0	18,0		0,050	-0151	9,00	-0151001	6,40	-0153	13,50	-0153001	11,00
20	52,0	12,0	19,0	22,0		0,070	-0201	9,70	-0201001	6,95	-0203	14,60	-0203001	11,80
25	70,0	20,0	25,0	28,0		0,110	-0251	7,25	-0251001	5,95	-0253	10,75	-0253001	8,85
32	78,0	23,0	31,0	34,0		0,150	-0321	8,90	-0321001	6,90	-0323	12,90	-0323001	10,50
40	85,0	25,0	37,0	40,0		0,210	-0401	9,80	-0401001	7,80	-0403	14,70	-0403001	12,10
50	97,0	27,0	49,0	52,0		0,280	-0501	12,20	-0501001	9,40	-0503	18,45	-0503001	14,85
65	110,0	30,0	66,0	70,0		0,570	-0651	18,25	-0651001	13,80	-0653	27,50	-0653001	22,15
80	118,0	28,0	81,0	85,0		0,790	-0801	51,00	-0801001	37,05	-0803	74,65	-0803001	61,25
100	140,0	40,0	100,0	104,0		1,200	-1001	65,50	-1001001	50,05	-1003	80,55	-1003001	69,15

 wb: walzblank
 matt gestrahlt auf Anfrage

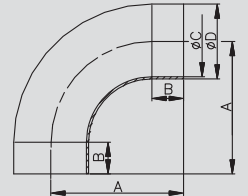
 wb: bright-rolled
 mat blasted on inquiry

**Walzbogen
DIN 90°**

**expanding bend
DIN 90°**
Art.-Nr. 33320-

							AISI 304L-1.4307				AISI 316L-1.4404			
DN	A	B	C	D	E	Gew.	Art.-Nr.	Preis	Art.-Nr.	Preis	Art.-Nr.	Preis	Art.-Nr.	Preis
							poliert	EUR	wb	EUR	poliert	EUR	wb	EUR
10	51,0	25,0	10,0	13,0		0,040	-0101	21,30	-0101001	19,30	-0103	25,00	-0103001	23,00
15	60,0	25,0	16,0	19,0		0,070	-0151	21,30	-0151001	19,30	-0153	25,20	-0153001	23,20
20	65,0	25,0	20,0	23,0		0,091	-0201	21,30	-0201001	19,20	-0203	30,00	-0203001	28,00
25	90,0	40,0	26,0	29,0		0,160	-0251	28,00	-0251001	26,00	-0253	35,50	-0253001	33,50
32	95,0	40,0	32,0	35,0		0,209	-0321	30,80	-0321001	28,80	-0323	38,00	-0323001	36,00
40	100,0	40,0	38,0	41,0		0,254	-0401	35,80	-0401001	32,80	-0403	43,50	-0403001	40,50
50	110,0	40,0	50,0	53,0		0,366	-0501	38,90	-0501001	35,80	-0503	47,00	-0503001	43,90
65	120,0	40,0	66,0	70,0		0,701	-0651	44,70	-0651001	39,90	-0653	56,50	-0653001	51,70
80	145,0	55,0	81,0	85,0		1,045	-0801	60,30	-0801001	50,60	-0803	75,10	-0803001	65,40
100	155,0	55,0	100,0	104,0		1,363	-1001	67,50	-1001001	57,60	-1003	93,10	-1003001	83,20
125	245,0	57,5	125,0	129,0		2,600	-1251	172,20	-1251001	156,20	-1253	221,90	-1253001	205,90

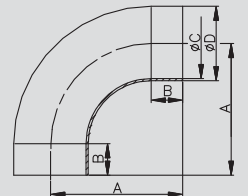
 wb: walzblank
 matt gestrahlt auf Anfrage

 wb: bright-rolled
 mat blasted on inquiry

**Schweißbogen
DIN 11852-BL 90°**

**welding bend
DIN 11852-BL 90°**
Art.-Nr. 33322-

							AISI 304L-1.4307				AISI 316L-1.4404			
DN	A	B	C	D	E	Gew.	Art.-Nr.	Preis	Art.-Nr.	Preis	Art.-Nr.	Preis	Art.-Nr.	Preis
							poliert	EUR	wb	EUR	poliert	EUR	wb	EUR
10	35,8	13,0	10,0	26,0	25,0	0,040	-0101	(+)	-0101001	(+)	-0103	(+)	-0103001	(+)
15	39,5	19,0	16,0	35,0	25,0	0,060	-0151	(+)	-0151001	(+)	-0153	(+)	-0153001	(+)
20	41,6	23,0	20,0	40,0	25,0	0,080	-0201	(+)	-0201001	(+)	-0203	(+)	-0203001	(+)
25	60,7	29,0	26,0	50,0	40,0	0,120	-0251	(+)	-0251001	(+)	-0253	(+)	-0253001	(+)
32	62,8	35,0	32,0	55,0	40,0	0,160	-0321	(+)	-0321001	(+)	-0323	(+)	-0323001	(+)
40	64,9	41,0	38,0	60,0	40,0	0,195	-0401	(+)	-0401001	(+)	-0403	(+)	-0403001	(+)
50	69,0	53,0	50,0	70,0	40,0	0,280	-0501	(+)	-0501001	(+)	-0503	(+)	-0503001	(+)
65	73,1	70,0	66,0	80,0	40,0	0,580	-0651	(+)	-0651001	(+)	-0653	(+)	-0653001	(+)
80	92,3	85,0	81,0	90,0	55,0	0,900	-0801	(+)	-0801001	(+)	-0803	(+)	-0803001	(+)
100	96,4	104,0	100,0	100,0	55,0	1,120	-1001	(+)	-1001001	(+)	-1003	(+)	-1003001	(+)
125	135,2	129,0	125,0	187,5	57,5	1,650	-1251	(+)	-1251001	(+)	-1253	(+)	-1253001	(+)

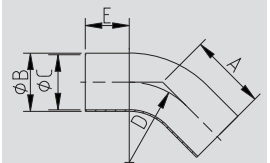
 wb: walzblank
 matt gestrahlt auf Anfrage

 wb: bright-rolled
 mat blasted on inquiry

**Schweißbogen
DIN 11852-BL 45°**

**welding bend
DIN 11852-BL 45°**

3.04 Schweiß- und Clampbogen
3.04 welding bend and clamp bend

Schweißbogen 5D DIN 90° welding bend 5D DIN 90°	Art.-Nr. 33306-							AISI 304L-1.4307				AISI 316L-1.4404			
	DN	A	B	C	D	E	Gew.	Art.-Nr.	Preis	Art.-Nr.	Preis	Art.-Nr.	Preis	Art.-Nr.	Preis
	mm	mm	mm	mm	mm	mm	kg	poliert	EUR	wb	EUR	poliert	EUR	wb	EUR
	10	35,0	9,0	12,0	35,0		0,021					-0103	32,85	-0103001	29,85
	15	50,0	15,0	18,0	50,0		0,048					-0153	33,15	-0153001	30,40
	20	60,0	19,0	22,0	60,0		0,060	-0201	31,20	-0201001	28,20	-0203	36,45	-0203001	33,40
	25	65,0	25,0	28,0	65,0		0,100	-0251	25,75	-0251001	22,95	-0253	29,30	-0253001	25,15
	32	75,0	31,0	34,0	75,0		0,110	-0321	35,60	-0321001	33,00	-0323	41,55	-0323001	38,95
	40	95,0	37,0	40,0	95,0		0,190	-0401	42,95	-0401001	36,90	-0403	52,90	-0403001	47,00
	50	125,0	49,0	52,0	125,0		0,370	-0501	47,55	-0501001	40,65	-0503	58,00	-0503001	51,10
	65	160,0	66,0	70,0	160,0		0,780	-0651	63,75	-0651001	58,80	-0653	73,00	-0653001	63,25
	80	200,0	81,0	85,0	200,0		1,170	-0801	73,60	-0801001	66,40	-0803	81,60	-0803001	70,60
	100	250,0	100,0	104,0	250,0		1,820	-1001	109,80	-1001001	97,70	-1003	114,55	-1003001	102,05
	125	312,5	125,0	129,0	312,5		3,100	-1251	333,00	-1251001	269,00	-1253	352,00	-1253001	288,00

wb: walzblank
 matt gestrahlt auf Anfrage

wb: bright-rolled
 mat blasted on inquiry

Schweißbogen 5D Reihe 2 90° welding bend 5D series 2 90°	Art.-Nr. 33326-							AISI 304L-1.4307				AISI 316L-1.4404			
	DN	A	B	C	D	E	Gew.	Art.-Nr.	Preis	Art.-Nr.	Preis	Art.-Nr.	Preis	Art.-Nr.	Preis
	mm	mm	mm	mm	mm	mm	kg	poliert	EUR	wb	EUR	poliert	EUR	wb	EUR
	10	40,0	10,0	13,0	40,0		0,026					-0103	33,40	-0103001	30,40
	15	50,0	16,0	19,0	50,0		0,052					-0153	35,60	-0153001	32,40
	20	55,0	20,0	23,0	55,0		0,069	-0201	38,20	-0201001	34,90	-0203	39,00	-0203001	35,70
	25	65,0	26,0	29,0	65,0		0,145	-0251	41,15	-0251001	37,15	-0253	42,25	-0253001	38,25
	32	75,0	32,0	35,0	75,0		0,148	-0321	42,90	-0321001	38,40	-0323	45,00	-0323001	40,50
	40	95,0	38,0	41,0	95,0		0,294	-0401	50,25	-0401001	45,25	-0403	52,85	-0403001	47,85
	50	125,0	50,0	53,0	125,0		0,380	-0501	64,40	-0501001	56,40	-0503	67,40	-0503001	59,40

wb: walzblank
 matt gestrahlt auf Anfrage

wb: bright-rolled
 mat blasted on inquiry

Bogen DIN CC 90° bend DIN clamp/clamp 90°	Art.-Nr. 34400-							AISI 304/304L-1.4301/1.4307				AISI 316L-1.4404			
	DN	A	B	C	D	E	Gew.	Art.-Nr.	Preis	Art.-Nr.	Preis	Art.-Nr.	Preis	Art.-Nr.	Preis
	mm	mm	mm	mm	mm	mm	kg	poliert	EUR	matt	EUR	poliert	EUR	matt	EUR
	10	44,0	10,0		26,0		0,080	-0101	47,55	-0102	44,25	-0103	54,45	-0104	50,70
	15	53,0	16,0		35,0		0,100	-0151	49,50	-0152	46,05	-0153	57,35	-0154	53,45
	20	58,0	20,0		40,0		0,120	-0201	50,15	-0202	46,75	-0203	58,40	-0204	54,40
	25	63,0	26,0		50,0		0,190	-0251	41,05	-0252	38,25	-0253	46,80	-0254	43,60
	32	68,0	32,0		55,0		0,240	-0321	51,45	-0322	47,95	-0323	61,65	-0324	57,45
	40	73,0	38,0		60,0		0,260	-0401	45,90	-0402	42,75	-0403	53,30	-0404	49,60
	50	83,0	50,0		70,0		0,310	-0501	51,65	-0502	48,10	-0503	60,10	-0504	55,95
	65	93,0	66,0		80,0		0,600	-0651	68,60	-0652	63,90	-0653	79,75	-0654	74,25
	80	103,0	81,0		90,0		1,000	-0801	90,80	-0802	84,55	-0803	110,10	-0804	102,50
	100	113,0	100,0		100,0		1,610	-1001	125,50	-1002	116,85	-1003	147,35	-1004	137,20

wb: walzblank
 matt gestrahlt auf Anfrage

wb: bright-rolled
 mat blasted on inquiry

3.05 Bogen mit Anschlüssen
3.05 bend with sockets
Art.-Nr. 34401-

Art.-Nr. 34401-							AISI 304/304L-1.4301/1.4307				AISI 316L-1.4404			
DN	A	B	C	D	E	Gew.	Art.-Nr.	Preis	Art.-Nr.	Preis	Art.-Nr.	Preis	Art.-Nr.	Preis
mm	mm	mm	mm	mm	mm	kg	poliert	EUR	matt	EUR	poliert	EUR	matt	EUR
1"	40,5	22,9		27,5		0,180	-1001	49,05	-1002	45,65	-1003	55,50	-1004	51,70
1,5"	58,0	35,1		45,0		0,270	-1121	55,30	-1122	51,50	-1123	64,30	-1124	59,85
2"	80,5	47,8		67,5		0,330	-2001	63,50	-2002	59,15	-2003	77,00	-2004	71,70
2,5"	95,5	60,2		82,5		0,490	-2121	84,25	-2122	78,45	-2123	99,90	-2124	93,00
3"	108,0	72,8		95,0		0,800	-3001	109,30	-3002	101,75	-3003	119,40	-3004	111,15
4"	146,5	97,4		133,5		1,500	-4001	148,75	-4002	138,50	-4003	170,50	-4004	158,75

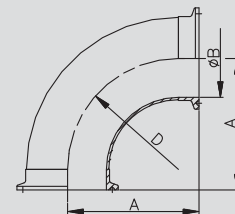
Bogen Zoll CC 90°
**bend inch
clamp/clamp 90°**

Art.-Nr. 35200-

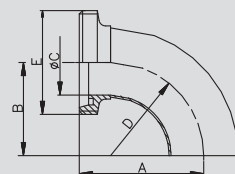
Art.-Nr. 35200-							AISI 304/304L-1.4301/1.4307				AISI 316L-1.4404			
DN	A	B	C	D	E	Gew.	Art.-Nr.	Preis	Art.-Nr.	Preis	Art.-Nr.	Preis	Art.-Nr.	Preis
mm	mm	mm	mm	mm	mm	kg	poliert	EUR	matt	EUR	poliert	EUR	matt	EUR
10	43,0	26,0	9,0	26,0	Rd28x1/8	0,040	-0101	20,50	-0102	19,10	-0103	26,65	-0104	24,80
15	52,0	35,0	15,0	35,0	Rd34x1/8	0,070	-0151	24,05	-0152	22,40	-0153	31,25	-0154	29,10
20	59,0	40,0	19,0	40,0	Rd44x1/6	0,130	-0201	25,95	-0202	24,15	-0203	33,70	-0204	31,35
25	72,0	50,0	25,0	50,0	Rd52x1/6	0,170	-0251	21,65	-0252	20,15	-0253	28,15	-0254	26,20
32	77,0	55,0	31,0	55,0	Rd58x1/6	0,220	-0321	23,55	-0322	21,95	-0323	30,65	-0324	28,50
40	82,0	60,0	37,0	60,0	Rd65x1/6	0,250	-0401	26,60	-0402	24,75	-0403	34,60	-0404	32,20
50	93,0	70,0	49,0	70,0	Rd78x1/6	0,470	-0501	30,95	-0502	28,80	-0503	40,20	-0504	37,45
65	105,0	80,0	66,0	80,0	Rd95x1/6	0,710	-0651	42,05	-0652	39,15	-0653	54,70	-0654	50,95
80	115,0	90,0	81,0	90,0	Rd110x1/4	0,930	-0801	68,10	-0802	63,40	-0803	102,15	-0804	95,10
100	130,0	100,0	100,0	100,0	Rd130x1/4	1,250	-1001	97,60	-1002	90,85	-1003	146,35	-1004	136,25
125	223,0	187,5	125,0	187,5	Rd160x1/4	2,900	-1251	229,40	-1252	213,55	-1253	263,15	-1254	245,00
150	265,0	225,0	150,0	225,0	Rd190x1/4	4,280	-1501	321,20	-1502	299,05	-1503	438,90	-1504	408,65

**Bogen GS
DIN 90°**
**bend DIN
male/weld.end
DIN 90°**

Rd: Rundgewinde

Rd: round thread

Art.-Nr. 35500-

Art.-Nr. 35500-							AISI 304/304L-1.4301/1.4307				AISI 316L-1.4404			
DN	A	B	C	D	E	Gew.	Art.-Nr.	Preis	Art.-Nr.	Preis	Art.-Nr.	Preis	Art.-Nr.	Preis
mm	mm	mm	mm	mm	mm	kg	poliert	EUR	matt	EUR	poliert	EUR	matt	EUR
10	43,0	9,0		26,0	Rd28x1/8	0,075	-0101	31,20	-0102	29,05	-0103	40,60	-0104	37,80
15	52,0	15,0		35,0	Rd34x1/8	0,120	-0151	36,60	-0152	34,10	-0153	47,70	-0154	44,40
20	59,0	19,0		40,0	Rd44x1/6	0,200	-0201	40,80	-0202	37,95	-0203	53,00	-0204	49,35
25	72,0	25,0		50,0	Rd52x1/6	0,245	-0251	33,85	-0252	31,55	-0253	44,15	-0254	41,10
32	77,0	31,0		55,0	Rd58x1/6	0,310	-0321	36,60	-0322	34,10	-0323	47,60	-0324	44,35
40	82,0	37,0		60,0	Rd65x1/6	0,400	-0401	39,90	-0402	37,15	-0403	51,85	-0404	48,25
50	93,0	49,0		70,0	Rd78x1/6	0,500	-0501	46,75	-0502	43,55	-0503	60,80	-0504	56,60
65	105,0	66,0		80,0	Rd95x1/6	0,900	-0651	63,35	-0652	59,00	-0653	82,50	-0654	76,80
80	115,0	81,0		90,0	Rd110x1/4	1,380	-0801	98,80	-0802	92,00	-0803	148,00	-0804	137,80
100	130,0	100,0		100,0	Rd130x1/4	2,320	-1001	139,90	-1002	130,25	-1003	209,85	-1004	195,40
125	223,0	125,0		187,5	Rd160x1/4	3,820	-1251	(+)	-1252	(+)	-1253	(+)	-1254	(+)
150	265,0	150,0		225,0	Rd190x1/4	5,840	-1501	(+)	-1502	(+)	-1503	(+)	-1504	(+)

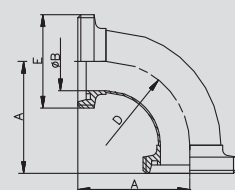
**Bogen GG
DIN 90°**
**bend DIN
male/male DIN 90°**

Rd: Rundgewinde

Rd: round thread

(+) Preis auf Anfrage

(+) price on inquiry

3.06 Bogen mit Anschlüssen
3.06 bend with sockets

Bogen GG DIN 45° bend male/male DIN 45°	Art.-Nr. 35502-							AISI 304/304L-1.4301/1.4307				AISI 316L-1.4404			
	DN	A	B	C	D	E	Gew.	Art.-Nr.	Preis	Art.-Nr.	Preis	Art.-Nr.	Preis	Art.-Nr.	Preis
	mm	mm	mm	mm	mm	mm	kg	poliert	EUR	matt	EUR	poliert	EUR	matt	EUR
10	38,5	9,0		26,0		0,073	-0101	30,20	-0102	28,05	-0103	39,45	-0104	36,65	
15	44,0	15,0		35,0		0,104	-0151	35,55	-0152	33,05	-0153	46,60	-0154	43,30	
20	48,5	19,0		40,0		0,173	-0201	39,70	-0202	36,85	-0203	51,75	-0204	48,10	
25	59,0	25,0		50,0		0,250	-0251	32,70	-0252	30,40	-0253	42,70	-0254	39,65	
32	62,5	31,0		55,0		0,280	-0321	35,30	-0322	32,80	-0323	45,85	-0324	42,60	
40	66,0	37,0		60,0		0,340	-0401	37,95	-0402	35,20	-0403	49,15	-0404	45,55	
50	74,5	49,0		70,0		0,410	-0501	44,25	-0502	41,05	-0503	57,60	-0504	53,40	
65	83,5	66,0		80,0		0,700	-0651	59,60	-0652	55,25	-0653	77,00	-0654	71,30	
80	90,5	81,0		90,0		1,120	-0801	91,65	-0802	84,85	-0803	138,00	-0804	127,80	
100	102,0	100,0		100,0		1,730	-1001	129,90	-1002	120,25	-1003	197,20	-1004	182,75	
125	170,0	125,0		187,5		2,830	-1251	(+)	-1252	(+)	-1253	(+)	-1254	(+)	
150	202,0	150,0		225,0		4,480	-1501	(+)	-1502	(+)	-1503	(+)	-1504	(+)	

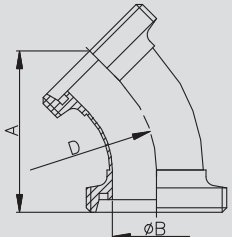

Bogen KG DIN 90° bend liner/male DIN 90°	Art.-Nr. 35600-							AISI 304/304L-1.4301/1.4307				AISI 316L-1.4404			
	DN	A	B	C	D	E	Gew.	Art.-Nr.	Preis	Art.-Nr.	Preis	Art.-Nr.	Preis	Art.-Nr.	Preis
	mm	mm	mm	mm	mm	mm	kg	poliert	EUR	matt	EUR	poliert	EUR	matt	EUR
10	43,0	39,0	9,0	26,0	Rd28x1/8	0,130	-0101	35,65	-0102	33,20	-0103	46,40	-0104	43,20	
15	52,0	48,0	15,0	35,0	Rd34x1/8	0,200	-0151	42,05	-0152	39,15	-0153	54,70	-0154	50,95	
20	59,0	53,0	19,0	40,0	Rd44x1/6	0,280	-0201	43,45	-0202	40,45	-0203	56,55	-0204	52,65	
25	72,0	65,0	25,0	50,0	Rd52x1/6	0,400	-0251	40,60	-0252	37,80	-0253	52,80	-0254	49,15	
32	77,0	70,0	31,0	55,0	Rd58x1/6	0,510	-0321	44,60	-0322	41,55	-0323	58,10	-0324	54,10	
40	82,0	75,0	37,0	60,0	Rd65x1/6	0,630	-0401	47,60	-0402	44,35	-0403	61,90	-0404	57,65	
50	93,0	86,0	49,0	70,0	Rd78x1/6	0,870	-0501	56,90	-0502	53,00	-0503	73,95	-0504	68,85	
65	105,0	97,0	66,0	80,0	Rd95x1/6	1,440	-0651	78,95	-0652	73,50	-0653	102,65	-0654	95,55	
80	115,0	107,0	81,0	90,0	Rd110x1/4	1,900	-0801	121,90	-0802	113,50	-0803	182,75	-0804	170,15	
100	130,0	120,0	100,0	100,0	Rd130x1/4	2,610	-1001	178,05	-1002	165,75	-1003	267,00	-1004	248,60	
125	223,0	211,0	125,0	187,5	Rd160x1/4	4,950	-1251	(+)	-1252	(+)	-1253	(+)	-1254	(+)	
150	265,0	252,0	150,0	225,0	Rd190x1/4	7,250	-1501	(+)	-1502	(+)	-1503	(+)	-1504	(+)	

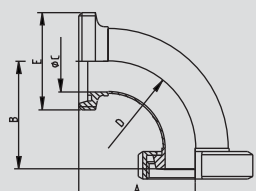

Rd: Rundgewinde

Rd: round thread

Bogen KG DIN 45° bend liner/male DIN 45°	Art.-Nr. 35602-							AISI 304/304L-1.4301/1.4307				AISI 316L-1.4404			
	DN	A	B	C	D	E	Gew.	Art.-Nr.	Preis	Art.-Nr.	Preis	Art.-Nr.	Preis	Art.-Nr.	Preis
	mm	mm	mm	mm	mm	mm	kg	poliert	EUR	matt	EUR	poliert	EUR	matt	EUR
10	38,5	9,0		26,0		0,090	-0101	34,65	-0102	32,20	-0103	45,25	-0104	42,05	
15	44,0	15,0		35,0		0,124	-0151	41,00	-0152	38,10	-0153	53,60	-0154	49,85	
20	48,5	19,0		40,0		0,215	-0201	42,35	-0202	39,35	-0203	55,30	-0204	51,40	
25	59,0	25,0		50,0		0,360	-0251	39,50	-0252	36,70	-0253	51,35	-0254	47,70	
32	62,5	31,0		55,0		0,430	-0321	43,30	-0322	40,25	-0323	56,35	-0324	52,35	
40	66,0	37,0		60,0		0,530	-0401	45,65	-0402	42,40	-0403	59,20	-0404	54,95	
50	74,5	50,0		70,0		0,560	-0501	54,40	-0502	50,50	-0503	70,75	-0504	65,65	
65	83,5	66,0		80,0		1,170	-0651	75,20	-0652	69,75	-0653	97,15	-0654	90,05	
80	90,5	81,0		90,0		1,700	-0801	114,75	-0802	106,35	-0803	172,75	-0804	160,15	
100	102,0	100,0		100,0		2,470	-1001	168,05	-1002	155,75	-1003	254,35	-1004	235,95	
125	170,0	125,0		187,5		3,960	-1251	(+)	-1252	(+)	-1253	(+)	-1254	(+)	
150	202,0	150,0		225,0		5,890	-1501	(+)	-1502	(+)	-1503	(+)	-1504	(+)	

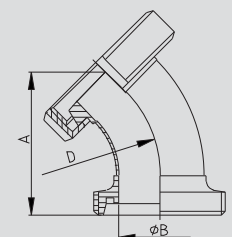

(+) Preis auf Anfrage

(+) price on inquiry

3.07 Bogen mit Anschlüssen
3.07 bend with sockets
Art.-Nr. 36200-

							AISI 304/304L-1.4301/1.4307				AISI 316L-1.4404			
DN	A	B	C	D	E	Gew.	Art.-Nr.	Preis	Art.-Nr.	Preis	Art.-Nr.	Preis	Art.-Nr.	Preis
mm	mm	mm	mm	mm	mm	kg	poliert	EUR	matt	EUR	poliert	EUR	matt	EUR
10	39,0	26,0	9,0	26,0		0,030	-0101	15,30	-0102	14,25	-0103	19,80	-0104	18,45
15	48,0	35,0	15,0	35,0		0,050	-0151	18,35	-0152	17,10	-0153	23,90	-0154	22,25
20	53,0	40,0	19,0	40,0		0,125	-0201	20,90	-0202	19,50	-0203	27,20	-0204	25,35
25	65,0	50,0	25,0	50,0		0,150	-0251	19,40	-0252	18,05	-0253	25,25	-0254	23,50
32	70,0	55,0	31,0	55,0		0,190	-0321	21,40	-0322	19,95	-0323	27,90	-0324	25,95
40	75,0	60,0	37,0	60,0		0,220	-0401	24,35	-0402	22,65	-0403	31,55	-0404	29,40
50	86,0	70,0	49,0	70,0		0,330	-0501	28,75	-0502	26,75	-0503	37,35	-0504	34,80
65	97,0	80,0	66,0	80,0		0,610	-0651	38,65	-0652	36,00	-0653	50,25	-0654	46,80
80	107,0	90,0	81,0	90,0		0,790	-0801	61,00	-0802	56,80	-0803	91,55	-0804	85,25
100	120,0	100,0	100,0	100,0		1,110	-1001	93,90	-1002	87,45	-1003	140,90	-1004	131,20
125	211,0	187,5	125,0	187,5		2,580	-1251	(+)	-1252	(+)	-1253	(+)	-1254	(+)
150	252,0	225,0	150,0	225,0		3,510	-1501	(+)	-1502	(+)	-1503	(+)	-1504	(+)

**Bogen KS
DIN 90°**

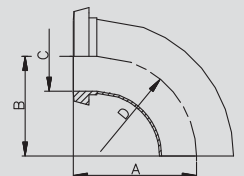
**bend
liner/weld.end
DIN 90°**

Art.-Nr. 36600-

							AISI 304/304L-1.4301/1.4307				AISI 316L-1.4404			
DN	A	B	C	D	E	Gew.	Art.-Nr.	Preis	Art.-Nr.	Preis	Art.-Nr.	Preis	Art.-Nr.	Preis
mm	mm	mm	mm	mm	mm	kg	poliert	EUR	matt	EUR	poliert	EUR	matt	EUR
10	39,0	9,0		26,0		0,180	-0101	39,20	-0102	36,50	-0103	50,95	-0104	47,45
15	48,0	15,0		35,0		0,220	-0151	46,95	-0152	43,70	-0153	61,05	-0154	56,85
20	53,0	19,0		40,0		0,370	-0201	47,70	-0202	44,40	-0203	62,05	-0204	57,75
25	65,0	25,0		50,0		0,535	-0251	47,60	-0252	44,35	-0253	61,90	-0254	57,65
32	70,0	31,0		55,0		0,650	-0321	53,20	-0322	49,50	-0323	69,10	-0324	64,35
40	75,0	37,0		60,0		0,755	-0401	56,30	-0402	52,40	-0403	73,20	-0404	68,15
50	86,0	49,0		70,0		1,000	-0501	67,00	-0502	62,35	-0503	87,15	-0504	81,15
65	97,0	66,0		80,0		1,835	-0651	94,85	-0652	88,30	-0653	123,25	-0654	114,75
80	107,0	81,0		90,0		2,650	-0801	144,00	-0802	134,10	-0803	216,05	-0804	201,15
100	120,0	100,0		100,0		4,100	-1001	215,10	-1002	200,30	-1003	322,70	-1004	300,45
125	211,0	125,0		187,5		6,080	-1251	(+)	-1252	(+)	-1253	(+)	-1254	(+)
150	252,0	150,0		225,0		8,660	-1501	(+)	-1502	(+)	-1503	(+)	-1504	(+)

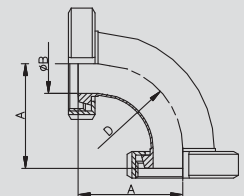
**Bogen KK
DIN 90°**

**bend
liner/liner DIN 90°**

Art.-Nr. 36602-

							AISI 304/304L-1.4301/1.4307				AISI 316L-1.4404			
DN	A	B	C	D	E	Gew.	Art.-Nr.	Preis	Art.-Nr.	Preis	Art.-Nr.	Preis	Art.-Nr.	Preis
mm	mm	mm	mm	mm	mm	kg	poliert	EUR	matt	EUR	poliert	EUR	matt	EUR
10	38,5	9,0		26,0		0,177	-0101	38,20	-0102	35,50	-0103	49,80	-0104	46,30
15	44,0	15,0		35,0		0,208	-0151	45,90	-0152	42,65	-0153	59,95	-0154	55,75
20	48,5	19,0		40,0		0,357	-0201	46,60	-0202	43,30	-0203	60,80	-0204	56,50
25	59,0	25,0		50,0		0,520	-0251	46,45	-0252	43,20	-0253	60,45	-0254	56,20
32	62,5	31,0		55,0		0,570	-0321	51,90	-0322	48,20	-0323	67,35	-0324	62,60
40	66,0	37,0		60,0		0,740	-0401	54,35	-0402	50,45	-0403	70,50	-0404	65,45
50	74,5	49,0		70,0		0,970	-0501	64,50	-0502	59,85	-0503	83,95	-0504	77,95
65	83,5	66,0		80,0		1,660	-0651	91,10	-0652	84,55	-0653	117,75	-0654	109,25
80	90,5	81,0		90,0		2,340	-0801	136,85	-0802	126,95	-0803	206,05	-0804	191,15
100	102,0	100,0		100,0		3,515	-1001	205,10	-1002	190,30	-1003	310,05	-1004	287,80
125	170,0	125,0		187,5		5,090	-1251	(+)	-1252	(+)	-1253	(+)	-1254	(+)
150	202,0	150,0		225,0		7,380	-1501	(+)	-1502	(+)	-1503	(+)	-1504	(+)

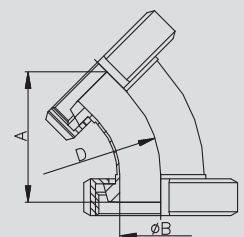
**Bogen KK
DIN 45°**

**bend
liner/liner DIN 45°**

(+) Preis auf Anfrage

(+) price on inquiry

3.08 Bogen 180°**3.08 bend 180°**

Schweißbogen DIN 180° welding bend DIN 180°	Art.-Nr. 38600-							AISI 304/304L-1.4301/1.4307				AISI 316L-1.4404			
	DN	A	B	C	D	E	Gew.	Art.-Nr.	Preis	Art.-Nr.	Preis	Art.-Nr.	Preis	Art.-Nr.	Preis
	mm	mm	mm	mm	mm	mm	kg	poliert	EUR	wb	EUR	poliert	EUR	wb	EUR
10	52,0	9,0	12,0				0,030	-0101	29,20	-0101001	26,30	-0103	31,00	-0103001	28,55
15	68,0	15,0	18,0				0,070	-0151	29,80	-0151001	26,70	-0153	32,60	-0153001	30,00
20	76,0	19,0	22,0				0,100	-0201	34,90	-0201001	32,10	-0203	36,75	-0203001	33,85
25	100,0	25,0	28,0				0,160	-0251	35,80	-0251001	32,30	-0253	38,40	-0253001	35,30
32	110,0	31,0	34,0				0,220	-0321	38,20	-0321001	34,80	-0323	40,90	-0323001	37,80
40	120,0	37,0	40,0				0,280	-0401	42,75	-0401001	40,30	-0403	52,65	-0403001	48,85
50	140,0	49,0	52,0				0,420	-0501	53,60	-0501001	50,20	-0503	66,55	-0503001	61,50
65	160,0	66,0	70,0				0,890	-0651	75,70	-0651001	71,10	-0653	93,80	-0653001	88,70
80	180,0	81,0	85,0				1,220	-0801	97,15	-0801001	90,95	-0803	132,05	-0803001	122,55
100	200,0	100,0	104,0				1,640	-1001	138,30	-1001001	128,20	-1003	188,40	-1003001	168,90

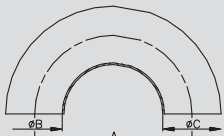

wb: walzblank
matt gestrahlt auf Anfrage
DN 65-100 gem. DIN 11852 - BS 180°

wb: bright-rolled
mat blasted on inquiry
DN 65-100 acc DIN 11852 - BS 180°

Schweißbogen DIN 11852-BS 180° welding bend DIN 11852-BS 180°	Art.-Nr. 38620-							AISI 304/304L-1.4301/1.4307				AISI 316L-1.4404			
	DN	A	B	C	D	E	Gew.	Art.-Nr.	Preis	Art.-Nr.	Preis	Art.-Nr.	Preis	Art.-Nr.	Preis
	mm	mm	mm	mm	mm	mm	kg	poliert	EUR	wb	EUR	poliert	EUR	wb	EUR
10	52,0	10,0	13,0				0,040	-0101	32,15	-0101001	28,95	-0103	34,10	-0103001	31,45
15	70,0	16,0	19,0				0,080	-0151	32,80	-0151001	29,40	-0153	35,90	-0153001	33,00
20	80,0	20,0	23,0				0,110	-0201	38,40	-0201001	35,35	-0203	40,45	-0203001	37,25
25	100,0	26,0	29,0				0,170	-0251	39,40	-0251001	35,55	-0253	42,25	-0253001	38,85
32	110,0	32,0	35,0				0,240	-0321	42,05	-0321001	38,30	-0323	44,70	-0323001	41,60
40	120,0	38,0	41,0				0,300	-0401	42,25	-0401001	39,55	-0403	52,15	-0403001	48,00
50	140,0	50,0	53,0				0,440	-0501	56,35	-0501001	52,60	-0503	70,00	-0503001	64,45

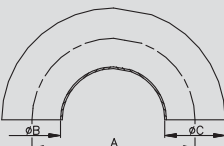

matt gestrahlt auf Anfrage
DN 65-100 siehe Art.-Nr. 38600

mat blasted on inquiry
DN 65-100 see item-no. 38600

Bogen KK DIN 180° bend liner/liner DIN 180°	Art.-Nr. 38900-							AISI 304/304L-1.4301/1.4307				AISI 316L-1.4404			
	DN	A	B	C	D	E	Gew.	Art.-Nr.	Preis	Art.-Nr.	Preis	Art.-Nr.	Preis	Art.-Nr.	Preis
	mm	mm	mm	mm	mm	mm	kg	poliert	EUR	matt	EUR	poliert	EUR	matt	EUR
10	52,0	9,0	39,0				0,186	-0101	53,45	-0102	49,20	-0103	69,55	-0104	64,00
15	68,0	15,0	48,0				0,228	-0151	61,55	-0152	56,65	-0153	80,10	-0154	73,65
20	76,0	19,0	53,0				0,400	-0201	62,50	-0202	57,50	-0203	81,25	-0204	74,75
25	100,0	25,0	65,0				0,510	-0251	73,35	-0252	67,50	-0253	95,40	-0254	87,80
32	110,0	31,0	70,0				0,755	-0321	80,00	-0322	73,60	-0323	104,05	-0324	95,70
40	120,0	37,0	75,0				0,920	-0401	92,40	-0402	85,35	-0403	119,75	-0404	110,60
50	140,0	49,0	86,0				1,150	-0501	110,00	-0502	101,40	-0503	142,90	-0504	131,75
65	160,0	66,0	97,0				2,210	-0651	156,80	-0652	145,00	-0653	203,30	-0654	188,00
80	180,0	81,0	107,0				3,160	-0801	231,55	-0802	213,80	-0803	345,75	-0804	319,15
100	200,0	100,0	120,0				5,720	-1001	319,95	-1002	282,10	-1003	474,60	-1004	417,75

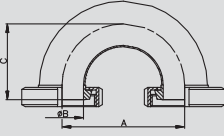



Armaturen GmbH

fon + 49 (0) 44 65 8 07 0
fax + 49 (0) 44 65 8 07 40



Armaturen GmbH

Armaturen, Rohre, Sonderteile aus Edelstahl
fittings, pipes, special parts of stainless steel

Industriestraße 24 - 26 · D-26446 Friedeburg
fon + 49 (0) 44 65 8 07 0 · fax + 49 (0) 44 65 8 07 40
mail: info@ms-armaturen.de · <http://www.ms-armaturen.de>